

Changing Lands Changing Hands



*A National Conference on Farm & Ranch
Access, Tenure & Transfer*

JUNE 13-15, 2017 | DENVER, COLORADO

Hosted by Land For Good in cooperation with
the United States Department of Agriculture

Venue Map

Room Abbreviations

PS: Prefunction South

A: Aspen

K: Keystone

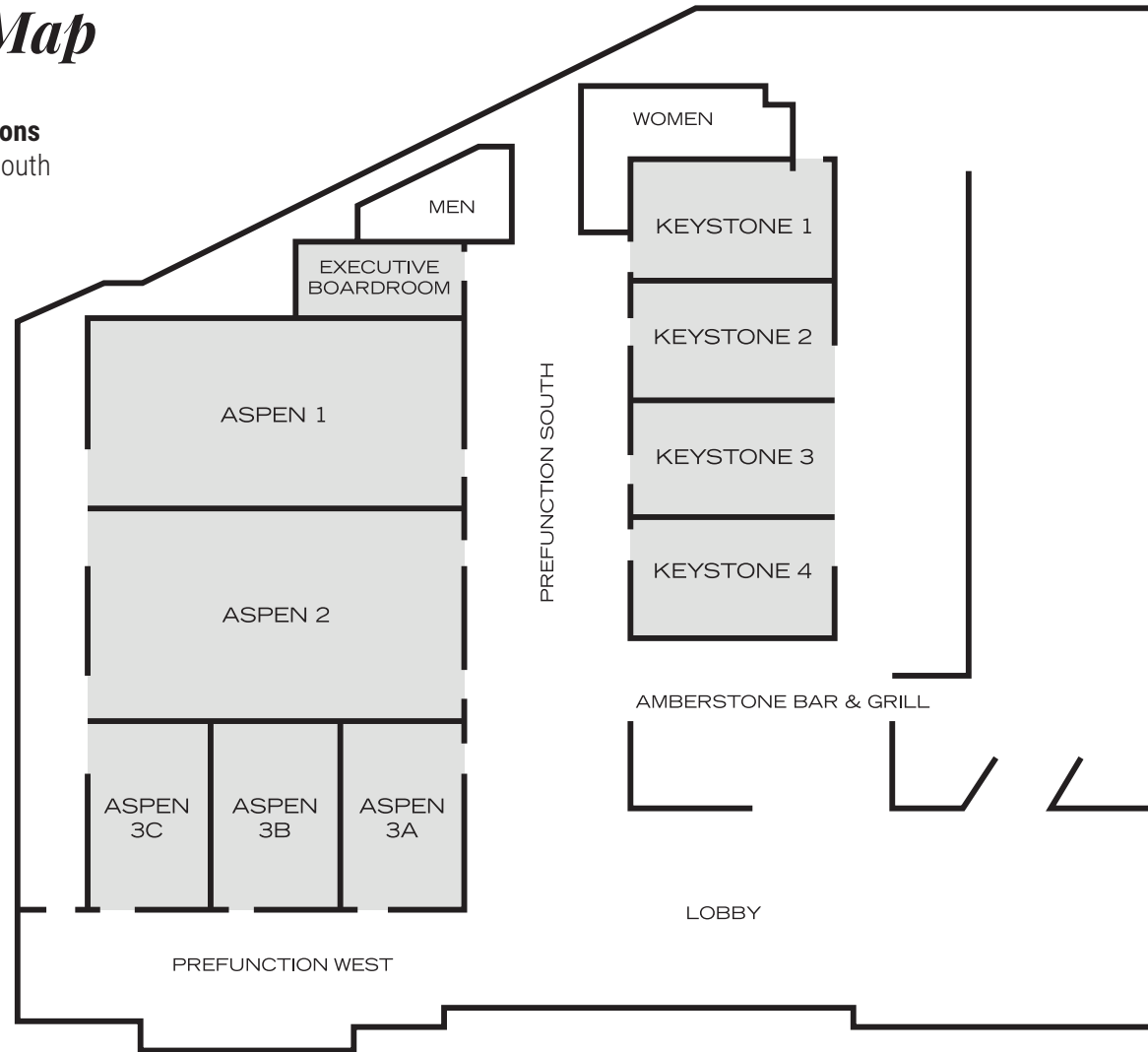

Schedule

Tuesday, June 13

1:00P | Registration Opens (PS)

3:00P | Opening Plenary (A:1&2)

► Welcome: Land For Good & Chris Beyerhelm,
Acting Administrator, USDA/FSA
► Panel

4:30P | Break (PS)

4:45P | Concurrent Session 1

6:15P | Reception (PS)

Hosted by Colorado Host Committee

7:15P | Dinner (A:1&2)

Remarks, Commissioner Don Brown,
Colorado Department of Agriculture

8:45P | Movie Night (K:1)

8:45P | Readers Theater (K:2)

Wednesday, June 14

7:00A | Breakfast (PS, A:1&2)

8:00A | Plenary Panel (A:1&2)

9:15A | Concurrent Session 2

10:45A | Break (PS)

11:15A | Concurrent Session 3

12:30P | Lunch & Plenary Panel (A:1&2)

2:15P | Concurrent Session 4

4:00P | Break (PS)

4:30P | Plenary Panel (A:1&2)

6:00P | Dinner on the town

6:00P | Excursion to Comal

If you pre-registered for this, meet in
front of hotel. Look for signs and a bus.

Thursday, June 15

7:00A | Breakfast (PS, A:1&2)

8:00A | Concurrent Session 5

9:30A | Break (PS)

9:45A | Regional Breakout Sessions
(See p. 5)

11:15A | Closing Plenary Panel (A:1&2)

12:30P | Adjourn

Welcome



An enterprising young rancher searches for secure land to grow his business. A senior farming couple anguishes over who will take over their farm. A landowner and her farmer-tenant negotiate over conservation practices. We all know stories like these. Land access and farm and ranch succession are top challenges for US agriculture. How will our farms and ranches be acquired, held and passed on? What will it take to assure secure and sustainable tenure and transfer for our nation's producers and landowners? These questions are of critical importance to the future of farming, food systems and farmland in the US.

We're here to tackle these issues together. You are among a growing group of individuals, organizations, and agencies working on land access, tenure and succession issues. This conference a forum for us to discuss successful and emerging practices, programs and policies. We have much to share with and learn from one another.

Together, we will:

- ✦ Exchange knowledge, information and research
- ✦ Assess what's going on in the field and what's needed
- ✦ Build our skills and networks
- ✦ Collect a wealth of ideas, experiences and perspectives

We are gathered here from all regions of the country, and from multiple sectors and disciplines. Diversity is essential to solving the complex challenges of land access, transfer and tenure. We'll consider all types and scales of farms, ranches and producers. And we'll need to address legal, financial, policy and natural resource dimensions, not to mention family dynamics, values and cultures!

Land For Good hosted the first *Changing Lands, Changing Hands* conference here in Denver in 2009. Since then, program and policy attention to agricultural land tenure has increased dramatically. With burgeoning interest in farming, growing public interest in food, and a new Administration, the timing is right for this event. Together we'll advance workable strategies for more equitable access to farm- and ranchland, secure and sustainable land tenure, and successful transfer of our farms and ranches.

Thank you so much for your commitment to America's farmers, ranchers and landowners—and for joining us at *Changing Lands, Changing Hands*. Welcome, and have a great time!

Jim Hafner, Executive Director

Kathryn Ruhf, Senior Program
Director & Conference Organizer

Contents

Conference Connections

2

Plenary Panels

3

Concurrent Sessions At-A-Glance

4

Concurrent Session Formats

Regional Breakout Sessions

5

Concurrent Session Descriptions

6-13

Presenters & Moderators

13-24

Attendees

25-33

Restaurants

Transportation

34

Movie Night

Readers Theater

35

About LFG & USDA

36

Committees & Acknowledgements

37

Be Social!

Join the conversation on
Twitter or Facebook using:
#LandChangingHands

WIFI Access

Network: DT
Password: 2-JUNE1.5

Conference Connections

Picking Your Brains

Changing Lands, Changing Hands brings together national leaders like you who are dealing with land tenure issues. One of our conference goals is to collect successful and emerging program, practices and policies on our topics. Land For Good will compile what we collect and share it widely in an online report.

Please contribute! Here's how we're going to gather all this information:

- ☞ A scribe will take notes in every session. She or he will collect your ideas, models, and practices on a form. Please help them by pointing out anything they should capture and by giving your name or a reference so we can follow up if needed.
- ☞ Videographers will be roaming the conference! If you are approached by someone with a smart device and an inquiring demeanor, please take a few minutes to share your work and ideas with them in a spontaneous, casual video interview that will be part of our post-conference report. Share your practices, perspectives and ideas to be included in our compilation, with all credit to you.
- ☞ Sticky notes, of course! Listen for instructions to post your practice, program and policy ideas and accomplishments.

Learning From Colleagues

Attendees routinely say that networking is the best part of any conference. Please take advantage of conference venue space dedicated to ad hoc meetings and get-togethers.

- ☞ **Hold a meeting** in the Executive Boardroom (capacity 14) any time during the conference. Sign up for a block of time. The sign-up sheet is posted at the Boardroom.
- ☞ **Hang out with colleagues** at the Amberstone Bar and Grill, located across from the registration table. This casual space is reserved for our event.
- ☞ **The Changing Lands Library Table** features resources from your colleagues. Thanks for adding yours. Please pick up your materials at the end of the conference.

Photo and Video Waiver

By attending this conference you may be included in video and/or photographs taken during the event. As part of your agreement to attend, you assign, transfer and grant to Land For Good the right to use your image and/or voice for educational and promotional purposes unless you expressly notify Land For Good to the contrary.



Equitable partition of land is the necessary basis of all self-sustaining agriculture. This partition and use of land may be in the form of ownership or in the form of right to hold the land for a specified time. The ownership may be of different degrees: the owner may have unlimited right to sell and to bequeath or he may be bound by certain statutory restrictions. Likewise, the rental of land may be of different degrees and kinds, and in some cases it may amount to practical ownership. These varying forms of land partition have arisen with the evolution of society.”

Liberty Hyde Bailey

CYCLOPEDIA OF AMERICAN AGRICULTURE, VOLUME IV, CHAPTER V LAND AND LABOR, 1909

Plenary Panels

TUESDAY 3:00P

Historic and Contemporary Perspectives on Farm and Ranch Tenure

This opening panel sets the stage for our conference work together. We'll get grounded with data and analyses from USDA. Then, panelists will share their perspectives on the issues. This provocative session will lay out values-based and practical challenges that guide—or thwart—our efforts to improve land access, tenure and transfer.

Panelists: Neil Hamilton, Drake University Agricultural Law Center, Lead Speaker; Dan Bigelow, USDA/Economic Research Service; Savi Horne, Land Loss Prevention Project; Scott Marlow, RAFI

Moderator: Kathryn Ruhf, Land For Good

.....
WEDNESDAY 8:00A

Public Policy Dimensions of Land Access and Transfer

Public policies can help advance our land tenure objectives or pose obstacles. Where are the promising levers? What is realistic? What can we do from the field? These policy experts will talk about the policy landscape at federal, state and local levels.

Panelists: Chris Beyerhelm, USDA/Farm Service Agency; Don Brown, Colorado Department of Agriculture; Cris Coffin, Land For Good; Gary Matteson, Farm Credit

Moderator: Juli Obudzinski, National Sustainable Agriculture Coalition

.....
WEDNESDAY 12:30P (LUNCH)

Farmer Panel

Hear stories from young and beginning farmers and ranchers about land access. These inspiring operators from different commodities and regions will share about their land tenure path and their perspectives on what's working and what's needed.

Panelists: Tess Brown-Lavoie, Sidewalk Ends Farm, Rhode Island; Harrison Topp, Topp Fruits, Colorado; Dustin Stein, Stubborn Farm, Colorado; Javier Zamora, JSM Organics, California

Moderator: Adrian Card, CSU Boulder County Extension

WEDNESDAY 4:30P

Racial Equity Challenges in Agricultural Land Tenure

US agricultural land tenure has a long and fraught history, especially regarding farmers of color and other disadvantaged groups. These panelists bring deep subject expertise to shed light on current challenges, and to provoke all of us to do more to promote equity in how all producers access, hold, and transfer farms and ranches.

Panelists: Stephen Carpenter, Farmers Legal Action Group; Janie Hipp, University of Arkansas; Shirley Sherrod, Southwest Georgia Project

Moderator: Jennifer Hashley, New Entry Sustainable Farming Project

.....
THURSDAY 11:15A

Where to Next?

Indeed! These panelists will translate their conference experiences and observations into key takeaways that are sure to inspire and challenge us all.

Panelists: Poppy Davis, Univ. of Arkansas School of Law; Julia Freedgood, American Farmland Trust; Lilia McFarland, USDA; Monica Ränge, Federation of Southern Cooperatives

Moderators: Jim Hafner & Kathryn Ruhf, Land For Good



Concurrent Sessions At-A-Glance

	Session 1 TUE 4:45P	Session 2 WED 9:15A	Session 3 WED 11:15A	Session 4 WED 2:15P	Session 5 THU 8:00A
Keystone 1	1B Farmers without Successors	2B Succession Tools, Methods & innovations	3A Role of Easements & Conservation	4A To Own or Not to Own?	5A Leases & Leasing
Keystone 2	1D Planning for Land Access	2D Shared Ownership, New Partners	3C Public Farm & Ranch Lands	4B Building Succession Advisor Teams	5C Women on the Land
Keystone 3	1F Urban Land Access	2E Land Access & Transfer Curricula	3E International Perspectives on Farm & Ranch Succession	4C Working with Non-operator Landowners	5G Industry Perspectives on Land Tenure
Keystone 4	1G Facilitating Good Transactions	2G Land & Water Rights	3F Heir Property, Partition Sales and Land Tenure	4D Incubators, Apprenticeships, Mentoring & Land Access	5F Land Tenure Advocates
Aspen 3A	1A Seekers' Land Access Needs	2A Access to Capital & Financing Land Access	3B Transition Planning & Farm Programs	4E: Farm Link Programs	5B Technical Issues in Transfer Planning Assistance
Aspen 3B	1C Non-operator Landowners	2C Connecting Landowners & Farmers	3D Paths to Ownership	4F Research & Policy Agenda	5D Farmland Investors
Aspen 3C	1E Attorneys in Access and Succession Assistance	2F Addressing Systemic Prejudice	3G Land Access for Military Veteran Farmers & Ranchers	4G New Agrarian Views on Land Tenure	5E Trusts, Land Access & Land Protection

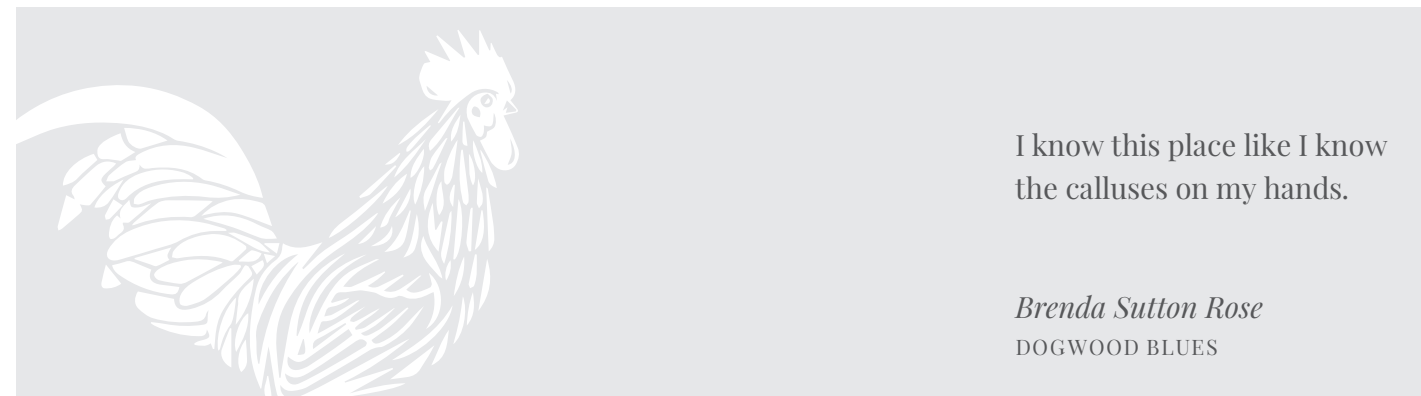

I know this place like I know the calluses on my hands.

Brenda Sutton Rose
DOGWOOD BLUES

Concurrent Session Formats

Tracks

Sessions are organized around six thematic tracks that are coded as follows to help you identify themes in the program:

- A** ▶ Seekers & Land Access
- B** ▶ Succession & Transfer
- C** ▶ Landowners
- D** ▶ Non-traditional Approaches
- E** ▶ Professional & Network Development
- F/G** ▶ Focus On... (a variety of key topics)

Formats

Presentation

In a presentation workshop, presenters share information about their work or program, followed by Q&A.

Discussion

In a discussion workshop, the discussants share their perspectives and analysis of the topic to set the stage for participant discussion.

Roundtables (Session 4)

These roundtable sessions are longer and more intensive than topical workshops. Here's where you can sink your teeth into an issue you care about! The sessions are in-depth, facilitated peer-to-peer discussion of specific topics leading to enhanced knowledge, understanding, practical applications and actions.

Each roundtable session is intended to foster:

- ▶ Greater understanding of the issues
- ▶ Practical next steps for individuals or collectively
- ▶ Exposure to best practices
- ▶ Problem identification and solving

Facilitators will set the stage and guide the discussion for each session. Choose a topic that resonates for you!

Regional Breakout Sessions THU 9:45A

In this session you will dialogue with colleagues from your part of the county. We'll explore how best and emerging practices, programs and policies address core land tenure values. We'll look at how regional characteristics and needs have shaped our work, and how we can best overcome challenges to achieve shared farm and ranch tenure goal—wherever we are.

Aspen 1-2: CO
Aspen 3A: IA, MI, MN, WI
Aspen 3B: CT, MA, ME, NH, RI, VT
Aspen 3C: NJ, NY, PA, WV

Keystone 1: ID, MT, NM, SD, TX, UT, WY
Keystone 2: AR, FL, GA, KY, MS, NC, SC, VA
Keystone 3: IL, IN, OH, MO, NE, KS
Keystone 4: CA, HI, OR, WA
DC and non-USA: your choice



My father worked with a horse plough,

His shoulders globed like a full sail strung

Between the shafts and the furrow.

The horses strained at his clicking tongue.

I wanted to grow up and plough

To close one eye, stiffen my arm.

All I ever did was follow

In his broad shadow around the farm.

I was a nuisance, tripping, falling,

Yapping always. But today

It is my father who keeps stumbling

Behind me, and will not go away.

Seamus Heaney
FOLLOWER

Concurrent Session Descriptions

Session 1 | Tuesday 4:45P

1A **Beginning Farmers' and Ranchers' and Other Seekers' Land Access Needs**

What are the characteristics and needs of beginning farmers and ranchers (stage of farming, region, etc.)? What do we need to know? We will discuss the implications for programs and policies to address their circumstances and challenges around land access.

Discussants: Mary Ahearn, USDA/Economic Research Service (retired); Tim Biello, American Farmland Trust; Holly Rippon-Butler, National Young Farmers Coalition

Moderator: Karen Stettler, Land Stewardship Project

1B **Farmers without Successors**

Many farmers and ranchers do not have identified successors. This is both a challenge and an opportunity. We'll examine research and programs focused on this audience. What do we know and how can we tailor assistance to their circumstances?

Presenters: Cris Coffin, Land For Good; Maria Marshall, Purdue University; Jon Jaffe, Farm Credit East

Moderator: Kip Kolesinskas

1C **Non-Operator Landowners**

Non-operator landowners (NOLOs) play a crucial role in agricultural land tenure and management. This session will focus on their needs and challenges, along with the programs that serve them.

Discussants: Chris Beyerhelm, USDA/FSA; Dan Bigelow, USDA/ERS; Peg Petrzelka, Utah State University

Moderator: Kim Niewolny, VA Tech

1D **Planning for Land Access**

Local and regional planners have increasingly engaged in agricultural land use and access. Presenters will share their methods and experiences. In addition, we'll take a look at the role of local governments in making land available and assisting transfers.

Presenters: Misti Arias, Sonoma County (CA); Julia Freedgood, American Farmland Trust; Pete Westover, Conservation Works

Moderator: Reggie Knox, California Farm Link



Remember the earth whose skin you are:

Red earth, black earth, yellow earth, white earth

brown earth, we are earth

Remember the plants, trees, animal life who all have their

tribes, their families, their histories too.

Joy Harjo

REMEMBER

1E **Attorneys in Access and Succession Assistance**

Discussants will focus on the roles and importance of attorneys' work with seekers, landowners and retiring producers, including how to engage more attorneys, build skills and strengthen networks. Not just for lawyers!

Discussants: Andrew Branan, attorney; Jerry Cosgrove, attorney; Joe Hawbaker, attorney

Moderator: Jim Hafner, Land For Good

1F **Urban Land Access**

Focus on the special practical and policy challenges around land access in urban settings. Presenters will draw from research and recent projects.

Presenters: Laura Bozzi, Southside Community Land Trust; Johanna Rosen, Equity Trust; Greg Rosenberg, Rosenberg & Associates

Moderator: Tess Brown-Lavoie, Land For Good

1G **Facilitating Good Transactions**

Navigating the "soft issues"—communications, goals & values—can make or break land access or transfer transactions. This session will focus on building service provider skills to assist these transactions.

Discussants: John Baker, Iowa State University Beginning Farmer Center; Dave Goeller, University of Nebraska; Kendra Johnson, California Farm Link

Moderator: Cara Cargill, Land For Good

Session 2 | Wednesday 9:15A

2A **Access to Capital and Financing Land Access**

Discussants will set a framework for the relationship between access to public and private capital and access to land, looking at the issues, options and policies around financing land acquisition.

Discussants: Reggie Knox, California Farm Link; Gary Matteson, Farm Credit; Jim Radintz, USDA Farm Service Agency

Moderator: Scott Marlow, RAFI

2B **Tools, Methods and Innovations in Succession and Transfer Planning Assistance**

Snapshots and stories from the field of successful and innovative strategies to engage farmers and ranchers in succession planning.

Presenters: Teresa Opheim, Practical Farmers of Iowa; Kristine Ranger, Ag Transition Partners; Jeff Tranel, Colorado State University; Julia Valliant, Indiana University

Moderator: Jerry Cosgrove, attorney

Session Descriptions



My father worked on a farm – and his father. They both got very near to ninety, I believe. They were hardy old sorts. They never had a thing amiss with them. They worked and lived, and then kind of toppled over at the end.

Ronald Blythe

AKENFIELD: PORTRAIT OF AN ENGLISH VILLAGE

2C Connecting Landowners and Farmers/Ranchers

Everybody's talking about "connecting" landowners and farmers. What does that mean? What works and what's needed? A frank look at programs and obstacles.

Discussants: Tim Biello, American Farmland Trust; Andrew Sorrell, Virginia Department of Agriculture; Jennifer Visitacion, Guidestone

Moderator: Holly Rippon-Butler, National Young Farmers Coalition

2D Shared Ownership, New Partners

New and young farmers across the country seek new ways to access land, and are drawn to cooperative, group options. This session will explore multi-farmer and farmer-non-farmer land ownership interests—their commonalities, unique challenges and emerging opportunities.

Presenters: Seth Jansen, Poudre Valley Community Farms; Ian McSweeney, Agrarian Trust; Jim Oldham, Equity Trust; Mike Sands, Liberty Prairie Foundation

Moderator: Kim Niewolny, Virginia Tech

2E Land Access and Transfer Curricula

Presenters will share their review of land access curricula and farmer training around land tenure, and their experiences developing curricula. What works for what audiences? What's missing?

Presenters: Julia Freedgood, American Farmland Trust; Andrew Marshall, Land For Good; Karen Stettler, Land Stewardship Project

Moderator: Jennifer Hashley, New Entry Sustainable Farming Project

2F Addressing Systemic Prejudice

A focus on the unique and shared challenges faced by socially disadvantaged groups dealing with land access. Discussants will set the stage for lessons learned and opportunities to overcome systemic prejudice to foster land access and secure tenure.

Discussants: Janie Hipp, University of Arkansas; Maria Moreira, World Farmers; Monica Rainge, Federation of Southern Cooperatives

Moderator: Jim Hafner, Land For Good

2G Land and Water Rights

In some US regions, water rights are integral to land tenure. What are the issues and implications around agricultural water use for land access and transfer?

Presenters: Aaron Clay, Attorney; Sarah Parmar, Colorado Open Lands

Moderator: Kathay Rennels, Colorado State University



Through my history's despite
and ruin, I have come
to its remainder, and here
have made the beginning
of a farm intended to become
my art of being here.
By it I would instruct
my wants: they should belong
to each other and to this place.
Until my song comes here
to learn its words, my art
is but the hope of song.

Wendell Berry
THE COLLECTED POEMS, 1957-1982

3A Role of Easements and Conservation

Easements play an important role in land affordability, availability and agricultural practices. Presenters will share their best and emerging practices around ag easements with a focus on land access and transfer, including more broadly the intersection of tenure and conservation.

Presenters: Jerry Cosgrove, attorney; Suzan Erem, SILT; Kendra Johnson, California Farm Link; Jillian Hishaw, F.A.R.M.S.

Moderator: Jennifer Dempsey, American Farmland Trust

3B Transition Planning & Farm Programs

The discussion will revolve around how transition planning does and could intersect with government and NGO programs and policy. Examples will be drawn from risk management, credit, conservation and mentoring programs.

Discussants: Kindra Brandner, Colorado NRCS; Scott Marlow, RAFI; Scott Miller, Colorado Farm Service Agency; Matt Russell, Drake Ag Law Center

Moderator: Cris Coffin, Land For Good

3C Public Farm and Ranch Lands

An investigation of farming and ranching agreements on federal, state, county and municipal properties. Presenters will share strategies, and explore ways to expand and improve the role of these land holders.

Presenters: Adrian Card, Colorado State University, Boulder County Extension; Tracy Emrick, Countryside Conservancy; Kip Kolesinskis, Connecticut Department of Agriculture; Les Owen, Colorado Department of Agriculture

Moderator: Andrew Marshall, Land For Good

3D Paths to Ownership

Land ownership is the dream of most farmers. What are established and new strategies for farmers and ranchers to move toward land ownership? Examples include lease-to-own, land contracts, and gradual transfer of interests. What current and potential policies foster a path to ownership?

Discussants: Gary Matteson, Farm Credit; Jim Radintz, USDA/Farm Service Agency; Kathy Ruhf, Land For Good; Liya Schwartzman, California Farm Link

Moderator: Bob Wagner, Land For Good

3E International Perspectives on Farm and Ranch

Learn from two experts who have studied farm transfer and land tenure in other countries and cultures. They will share their research and observations, with examples and application to the U.S.

Presenters: John Baker, International Farm Transition Network and Iowa State University; Matt Loble, Land Environment, Economics and Policy Institute, University of Exeter, UK

Moderator: Dave Goeller, University of Nebraska



If we wish to know why it is becoming more and more difficult for a farmer to acquire the ownership of land, we must study those forces and conditions that enable him to buy land, and also the conditions that retard his making investments in land. To improve the conditions with respect to the ownership of farms, some means of improving the farmer's facilities for making such acquisitions need to be devised.

Liberty Hyde Bailey
CYCLOPEDIA OF AMERICAN AGRICULTURE, VOLUME IV, CHAPTER V LAND AND LABOR, 1909



3F Heir Property, Partition Sales and Land Tenure

Heir property and partition sales present barriers to successful transfer of land to the next generations of African American and Native American farmers and ranchers. What are the program and policy opportunities to address this long-standing issue?

Presenters: Savi Horne, Land Loss Prevention Project; Monica Rainge, Federation of Southern Cooperatives; Cris Stainbrook, Indian Land Tenure Foundation

Moderator: Cara Cargill, Land For Good

3G Land Access for Military Veteran Farmers & Ranchers

This session will focus on the particular challenges faced by military Veterans accessing land for their farm or ranch operation.

Presenters: Jim Craig, Colorado AgrAbility; Matt Mulder, Arcadia Foods; TBD

Moderator: Rachel Murray, Land For Good

Session 4 (Roundtables) | Wednesday 2:15P

4A To Own or Not to Own: Is that the Question?

What are our goals and priorities for land access and tenure in the U.S.? What factors need to be considered? This roundtable will use the constructive tensions around land tenure toward a useful framework for our collective work.

Facilitators: Chris Beyerhelm, USDA Farm Service Agency; Neil Hamilton, Drake University Agricultural Law Center

4B Building Succession Advisor Teams

It takes a team to help farm and ranch families plan for succession. In this roundtable, practitioners will dig into how to build and improve succession planning advisor teams. Issues may include communications, confidentiality, and coordination challenges, along with strategies to recruit and train providers.

Facilitators: Teresa Opheim, Practical Farmers of Iowa; Andrew Marshall, Land For Good

4C Working with Non-operator Landowners

Few services exist for non-operator landowners. This roundtable will brainstorm successful and emerging practices to engage, educate and support NOLOs, from making land their available to working with USDA programs.

Facilitators: Jim Hafner, Land For Good; Matt Russell, Drake University Agricultural Law Center

I should understand the land, not as a commodity, an inert fact to be taken for granted, but as an ultimate value, enduring and alive, useful and beautiful and mysterious and formidable and comforting, beneficent and terribly demanding, worthy of the best of man's attention and care...

Wendell Berry
THE HIDDEN WOUND

4D Incubators, Apprenticeships, Mentoring & Land Access

Creative thinking about how land-based farmer training and mentoring programs address land access for trainees. This roundtable will draw from participants' experiences and tackle the synergies between farmer training and land transfer.

Facilitators: Jennifer Hashley, New Entry Sustainable Farming Project and National Incubator Farm Training Initiative; Sarah Wentzel-Fisher, Quivira Coalition

4E Farm Link Programs

What are linking programs? Do they work, and how do we know? A clinic on program design, challenges, metrics, sustainability and effectiveness for those in the linking trenches and those who hope to be.

Facilitators: Andy Sorrell, VA Department of Agriculture; David Haight, American Farmland Trust

4F Research and Policy Agenda

A deep dive for policy and research wonks and wannabes. This roundtable will explore policy options and strategies for the next Farm Bill, state-level policy opportunities and research priorities.

Facilitators: Cris Coffin, Land For Good; Poppy Davis, SAGE

4G New Agrarian Views on Land Tenure

How can visions and models "outside the box" inform and inspire our collective efforts on equitable land access and transfer? This roundtable will combine creative thinking, cutting edge, real-world examples and analysis.

Facilitators: Julia Freedgood, AFT; Jean Willoughby, Agrarian Trust

Session 5 | Thursday 8:00A

5A Leases and Leasing

Presenters will dive into perspectives on leasing—the types and suitability of leases, and their legal and policy dimensions. We'll address roles and skills for TA providers to assist with good farm lease agreements.

Presenters: Neil Hamilton, Drake Ag Law Center; Liya Schwartzman, California Farm Link; Kathryn Ruhf, Land For Good

Moderator: Adrian Card, Colorado State University Extension, Boulder Cty

5B Technical Issues in Transfer Planning Assistance

Discussion of the hurdles advisors face with their transition clients—such as entity formation, taxes, operating agreements, and financial viability. What are good practices and areas for improved techniques?

Discussants: Andrew Branan, attorney; Dave Goeller, University of Nebraska; Savi Horne, Land Loss Prevention Project; Jon Jaffe, Farm Credit East

Moderator: Joe Hawbaker, attorney



We abuse land because we regard it as a commodity belonging to us. When we see land as a community to which we belong, we may begin to use it with love and respect.

Aldo Leopold
A SAND COUNTY ALMANAC

5C Women on the Land

Exemplary and emerging programs for women who hold or seek access to agricultural land.

Presenters: Wren Almitra, Women, Food and Agriculture Network; Debra Heleba, University of Vermont; Joy Kirkpatrick, University of Wisconsin; Madeline Schultz, Annie's Project, Iowa State University

Moderator: Laura Bozzi, Southside Community Land Trust

5D Farmland Investors

Sharing research on and examples of farmland investors, discussants will set the stage for dialogue, including concerns and opportunities related to farmland investment entities.

Discussants: Tim Biello, Saratoga Draft Power Farm; Mike Ghia, Land For Good; Teresa Opheim, Iroquois Valley Farms; Benneth Phelps, Dirt Capital Partners

Moderator: Bob Wagner, Land For Good

5E Land Trusts, Land Access and Land Protection

What are the current and best strategies to engage and strengthen land trusts in agricultural land protection, access and transfer? This session will explore successful, emerging and potential land trust community roles, contributions and connections.

Discussants: Nellie McAdams, Rogue Farm Corps; Jim Oldham, Equity Trust; Karen Burke, Sisters of St. Joseph of Brentwood; Holly Rippon-Butler, National Young Farmers Coalition

Moderator: Kendra Johnson, California Farm Link

5F Land Tenure Advocates: Individualized Support, System-wide Impact

Farm advocates will share their case-based experiences and strategies that bring a social justice lens to land tenure work within a food system reform framework.

Discussants: Stephen Carpenter, Farmers Legal Action Group; Scott Marlow, RAFL; Shirley Sherrod, Southwest Georgia Project

Moderator: Alicia Harvey, Farm Aid

5G Industry Perspectives on Land Tenure

Ag industry representatives will share their positions and perspectives on land access and transfer issues faced by their constituency, and their thoughts on the political landscape to address agland tenure challenges.

Presenters: Tom Driscoll, National Farmers Union; Zandon Bray, Colorado Farm Bureau; TBD

Moderator: Gary Matteson, Farm Credit



Awake! arise! the athlete's arm
Loses its strength by too much rest;

The fallow land, the untilled farm
Produces only weeds at best.

Henry Wadsworth Longfellow
A FRAGMENT IN IN THE HARBOR

These memories are part of
my heritage, the fabric of my
personality, and as real to me
as the land itself.

Karen Jones Gowen
FARM GIRL

Presenters & Moderators

Dr. Mary Clare Ahearn is a Consulting Agricultural Economist. She retired from the USDA Economic Research Service in 2014 after more than 35 years of service as a researcher and research manager, specializing in policy analysis of agricultural performance, farm structure and rural development. Since retiring, she served as Managing Editor, Choices Magazine, an outreach magazine of the Agricultural and Applied Economics Association and Vice-Chair, Council of Food, Agriculture, and Resource Economics, an organization dedicated to strengthening the national presence of the profession. She provides economic consulting to international and national organizations. She received her Ph.D. from Oregon State University in 1984.

Wren Almitra coordinates Women, Land & Legacy, a USDA outreach program coordinated through the Women, Food & Ag. Network (WFAN). She also assists with WFAN's Harvesting Our Potential program, which supports aspiring and beginning women farmers. A life-long resident of Iowa, she took a leave of absence for a few years to receive her Environmental Studies degree from Prescott College in Prescott, AZ where she studied Agroecology, among other sustainable agriculture and conservation biology courses. She's worked on small farms in Iowa and Arizona and is a supporting partner of The Millet Seed, a CSA urban farm in Iowa City, IA.

Misti Arias is the Acquisition Program Manager of the Sonoma County Agricultural Preservation and Open Space District. The District was created and funded by local voter initiative to protect a wide variety of land throughout Sonoma County, California. Since 1990, the District has permanently protected over 111,000 acres. As a program manager, Misti oversees a wide variety of land conservation efforts for wildlife habitat, greenbelts, recreation and agriculture. She has over 20 years of agricultural land conservation experience ranging from the development of small scale community farms to 1,200 acre agricultural conservation easements on privately owned land.

Attorney John R. Baker is employed by Iowa State University Extension. For the last 32 years his focus has been on developing researched based materials, programs and presentations on the issues of farm entry, farm business succession planning and coordinating farm business owners in the development of their succession plans. He is a co-founder of the International Farm Transition Network and the FARMTRANSFERS

research project. He wrote the legislation that created the Iowa Beginning Farmer Center and the Beginning Farmer Tax credit. He has lectured throughout the United States and in Canada, Japan, Ireland, England, New Zealand and Poland.

Since January 2017, **Chris Beyerhelm** has served as Acting Administrator of the Farm Service Agency, overseeing policy, programs, operations, and management. It employs over 11,000 people in 2,100 offices nationwide. Concurrently, Mr. Beyerhelm has served as Associate Administrator for Operations and Management since 2015, wherein he is responsible for overseeing FSA's budget, management and operations. Mr. Beyerhelm serves as the Lead of USDA's Land Tenure Initiative. Previously, Mr. Beyerhelm was Deputy Administrator for Farm Loans Programs, where he oversaw a \$20 billion portfolio and managed the direct and guaranteed lending programs of FSA.

As Hudson Valley Farmlink Network Coordinator **Tim Biello** manages farmer and farmland owner programming, such as workshops and networking events, administers the Hudson Valley Farmland Finder.org website, and provides technical assistance to farmers and farmland owners in the Hudson Valley and throughout New York. He also organizes and presents at professional development training programs and assists with or leads research projects in New York and New England. Tim has an MS in Rural Sociology with a focus on agriculture, natural resources and community development. Tim is also a beginning farmer, managing and operating on 60 acres outside of Saratoga Springs, NY.

Daniel Bigelow joined USDA's Economic Research Service in 2015 as a research economist in the Rural and Resource Economics Division. Dan was involved with the initial analysis of TOTAL, a unique USDA survey that provides a comprehensive depiction of U.S. farmland ownership, tenure, and transfer. His current projects include a number of policy-focused research applications related to land use, land valuation, and water management. Dan holds a Ph.D. in Applied Economics, with a focus on environmental and resource economics, from Oregon State University.

Laura Bozzi is the Director of Programs at the Southside Community Land Trust in Providence, RI. There she leads programs aimed at building a food system that works for everybody: from farmland

access and urban agriculture to beginning farmer training and aggregation/distribution. She joined SCLT in January 2015, after working across the United States – from Oregon to West Virginia to Washington, DC – in fisheries, food systems and environmental protection. She earned Ph.D. and master's degrees from Yale University in Forestry and Environmental Studies and a B.S. in Ecology and Evolutionary Biology, also from Yale University.

Attorney Andrew Branan has worked with farmers and rural landowners since 2002. The core of his practice is helping families plan for the disposition of farm assets, usually with the goal of keeping them producing into another generation. Areas of expertise include: farm estate planning and farm business succession, conservation easements, Present Use Value property tax, PACA, farm leases, farm and processing business entity development and management, agri-tourism issues, estate settlement where farmland and farm equipment are assets, heir property/quiet title; non-profit organization and program development, and about any question related to farm law and rural land.

Kindra Brandner is the Environmental Quality Incentive Program (EQIP) Specialist for the Colorado Natural Resources Conservation Service (NRCS) located under the United States Department of Agriculture (USDA). Kindra graduated from Colorado State University with a Bachelor of Science in Rangeland Ecology and has worked for the NRCS since 1997. Kindra is also a graduate of the Emerging Leadership Development Program sponsored by the NRCS and The George Washington University. Kindra is a Colorado native from the rural agriculture community in Yuma and enjoys the opportunity to work one on one with landowners around the state.

Zandon Bray helps manage Bray Ranch. He returned to this multi-generation ranch in 2008. Bray Ranch began in 1907 when Edgar Bray and his wife moved by horse-drawn carriage from Cedaredge to Redvale, Colorado. The ranch began as a small operation but grew to a 800 cow-calf and yearling operation along with sheep and an extensive hunting operation. Zandon is president of Colorado Farm Bureau's Monstrose, Ouray and San Miguel County District 10. He is married to Sara, a school teacher. They have three children.

Don Brown was appointed the Colorado Commissioner of Agriculture in 2015. Brown is a third-generation farmer in Yuma County, Colorado. The Brown family farm was homesteaded in 1911 and has been des-

ignated as a Centennial Farm. Brown continues that pioneering spirit today through his study of the Ogallala Aquifer and his work related to water conservation, energy development and designing and implementing technological innovations within the industry. He is active in the National Cattlemen's Association, Colorado Cattlemen's Association, National Corn Growers and the Colorado Corn Growers Association. Brown is also a former Colorado State President of the Future Farmers of America.

Tess Brown-Lavoie is a first-generation farmer at Sidewalk Ends Farm outside of Providence, RI, which she started with her sisters in 2011. She is the RI Field Agent at Land For Good, and coordinates the Justice and Agriculture Working Group. Through these organizations, she works on land access, succession planning, and other various challenges faced by farmers in accessing land and capital, connecting with markets and resources, and addressing structural racism and other forms of oppression. She is Vice President of the National Young Farmers Coalition Board.

Karen Burke, CSJ, Ed.D. is the Coordinator of Land Initiatives for the Congregation of the Sisters of St. Joseph, Brentwood, NY. In response to the Congregation's Land Ethic statement, S. Karen has coordinated the efforts to implement new initiatives related to land conservation, solar energy, landscape options, and wastewater management. The Congregation's 212-acre property contains significant natural and community resources. S. Karen is leading the collaboration with the Peconic Land Trust to protect this land that is held in sacred trust. Most importantly, 28 acres of working farms will be preserved in perpetuity through a permanent agricultural easement on our property. The farm fields that once were working farmlands are now leased to six local farmers.

Adrian Card serves as the CSU Extension Agent in Agriculture and Natural Resources in Boulder County since 2004. He has worked in local foods in Colorado for the past 20 years as a vegetable farmer in Larimer County and as a student, instructor and researcher at CSU, and continues that work in his current position working directly with farmers, NGOs, and the public sector. Adrian's Extension work focusses on cropping systems, food systems, specialty crop production and marketing, public ag education, beginning farmer development, ag community development, economic development, and organizational development support for the Colorado Fruit and Vegetable Growers Association.

Cara Cargill is Land For Good's New Hampshire Field Agent. She also works as a facilitator and mediator covering a spectrum of areas from agriculture, food systems, land access/tenure/transfer, to family systems, and civic engagement including as mediator and program coordinator for the New Hampshire Agricultural Mediation Program, contractor with the State of NH as the North Country FAIR facilitator, NH Listens Carsey Fellow, and junior associate of Essential Partners. She received her MS in Mediation and Applied Conflict studies from the Woodbury Institute of Champlain College. Across all domains she is interested in creating constructive conversations.

Stephen Carpenter is Deputy Director at Farmers' Legal Action Group, Inc. (FLAG), a nonprofit law firm that works on behalf of family farmers. His work has centered on discrimination in agriculture, debtor-creditor issues, sustainable agriculture, direct marketing, and contracting in agriculture. He was Senior Counsel in the Office of the Monitor in the Pigford case and is the court-appointed Ombudsman for the In re Black Farmers Discrimination case. Stephen has presented to farmers and advocates in about thirty states. He graduated from Drury College and Stanford Law School, was a Stanford Law Review Executive Editor, and received a Skadden Foundation Fellowship that brought him to FLAG.

Aaron Clay has practiced law in Delta, Colorado since 1980. His general practice focuses on real estate, water, business planning, and estate planning. He was the Water Referee for Colorado Water Court, Division 4 (Gunnison, Uncompahge, and San Miguel River Basins) from 1982 to 2008. Among his clients are Tri-County Water Conservancy District, Grand Mesa Water Conservancy District, North Fork Water Conservancy District, Grand Mesa Water Users Association, and numerous other ditch companies and water users. Aaron has taught a course titled Water Law in a Nutshell for several years, for realtors, closers, attorneys, and others.

Cris Coffin leads Land For Good's efforts to promote and strengthen state and federal policies around farmland access, tenure, transfer and succession. Since the 1980's, Cris has worked at all levels of government on agriculture and land conservation policy. Past positions include New England Director/American Farmland Trust, Professional Staff Member/U.S. Senate Committee on Agriculture, Nutrition and Forestry, Legislative Assistant and Chief of Staff/U.S. Senator Herb Kohl, and consultant to the Vermont

and Wisconsin Departments of Agriculture. Cris is a graduate of the University of Massachusetts (B.A.) and Georgetown University Law Center (J.D.), and, with her husband, raises pastured poultry in Bernardston, Massachusetts.

Jerry Cosgrove is a Senior Advisor and Farm Legacy Program Director with American Farmland Trust and is Of Counsel at the law firm of Scolaro, Fetter, Grizanti, McGough and King, P.C. Jerry served as Associate Director of the Local Economies Project of the New World Foundation from 2012 to 2015, and as Deputy Commissioner for the NY Department of Agriculture and Markets from 2007 to 2010. He was Northeast Director for American Farmland Trust for 15 years. Jerry grew up on his family's dairy farm in Clinton, NY. Jerry graduated from Cornell's College of Agriculture and Life Sciences and Cornell Law School.

James Craig MA; JD; Ph.D. is a Rural Rehabilitation Specialist with the Colorado AgrAbility Project at Goodwill Industries Denver. Mr. Craig was raised on a Winter Wheat/Cow-Calf Operation in NE Montana. Combining 28 years of service in the United States Marine Corps with ranch upbringing and academic degrees in law, mental health counseling and psychology, he has served as a Staff Judge Advocate, agricultural lawyer, Judge Pro Tempore and therapist. Mr. Craig will present information that the impaired veteran may use to improve access to farm ownership.

Poppy Davis teaches and advises on business and policy issues affecting family-scale farms and ranches and related associations. She is the Director of Entrepreneurship at the Indigenous Food and Agriculture Initiative at the University of Arkansas Law School and consults for farm programs across the country. Previously she was the National Program Leader for Small Farms and Beginning Farmers and Ranchers at the USDA, and prior to that a California CPA. She holds a Juris Doctor Agriculture from Drake University Law School, a Masters in Journalism from Georgetown, and a BS in Agricultural Economics from the University of California, Davis.

Jennifer Dempsey is the Director of American Farmland Trust's Farmland Information Center (FIC), a project of AFT and USDA Natural Resources Conservation Service that includes a staffed answer service and clearinghouse of farmland protection resources at: www.farmlandinfo.org. Dempsey oversees delivery of technical assistance, develops educational resources, and monitors farmland protection activity including an

annual survey of purchase of agricultural conservation easement programs. She co-authored *Cultivating the Next Generation: Resources and Policies to Help Beginning Farmers Succeed in Agriculture* and is co-leading a Beginning Farmer and Rancher Development project to develop a performance-based land access curriculum for beginning farmers and ranchers.

Tom Driscoll joined National Farmers Union in 2014. He works to ensure family farmers, beginning farmers and youth have the educational resources they need to succeed. He also represents their interests on energy, climate and environmental issues. Before joining NFU, Driscoll managed the agriculture news clips service AgToGo, wrote articles for the Agri-Pulse weekly newsletter, and helped nonprofits apply to USDA grant programs. He has also worked for the U.S. EPA, Congressman Tim Ryan, and the boutique government relations firm Strategies 360. A licensed attorney in NY and DC, he holds a JD from the University of Toledo College of Law.

Tracy Emrick is Executive Director at Cuyahoga Valley Countryside Conservancy. After the passing of founder Darwin Kelsey, Tracy, who's been with Countryside since 2012, was selected to serve as the new ED in March 2017. In partnership with Cuyahoga Valley National Park, Countryside co-manages a unique farmland program. In addition to this model and Countryside's other local food programs, Tracy advocates for farmers and farmland preservation across Ohio. She is a Political Science graduate of Kent State University, and a proud, active member of the Ohio Farm Bureau. Tracy lives in northeast Ohio on a tiny farm once belonging to her grandparents.

Suzan Erem is president and co-founder of the Sustainable Iowa Land Trust, dedicated to permanently protecting land to grow healthy food. She combines three decades of organizing experience with her passion for economic justice and environmentalism in this effort to revive the family food farm on Iowa's industrial agriculture landscape. In SILT's first two years, it has acquired three farms and placed next generation farmers on two. SILT is on pace to protect three more farms this year. SILT credits Equity Trust, Slow Money and the broader land trust community for much of the success of its model.

Julia Freedgood is Assistant Vice President of Programs at American Farmland Trust responsible for AFT's mission areas to protect farmland and keep farmers on the land. She oversees planning, policy and

programming related to farmland protection, farmland transition and access, food systems, and the next generation of farmers. Freedgood leads AFT's Farms for the Next Generation initiative, which includes a four year USDA-funded project to train trainers to help beginning farmers and ranchers secure land. She also is wrapping up Growing Food Connections, a research, extension and education project to build local government capacity to sustain agriculture and strengthen community food systems.

Mike Ghia was a Vermont beginning farmer and land seeker from 1997-2007. Now he farms part-time while working as a farm consultant, primarily as Land For Good's Vermont Field Agent, and with the University of Vermont Extension Farm Viability Program, where he assists farmers with business planning, financial management and farm succession. As LFG Field Agent, Mike coaches farmers and landowners on farmland access and tenure, and develops tools and technical resources to help farmers and landowners with farmland tenure issues, including farm succession and transfers.

Dave Goeller began his career at the University of Nebraska Department of Ag Economics in 1984. Since the late 1990's he served as UNL Extension "Farm Transition Specialist" with an emphasis on beginning farmer and family business transition and estate planning as well as farm financial management. The author of numerous articles and publications, Goeller has trained and presented in more than 30 States and in Canada. Recently retired, Dave continues to do contract work on farm/ranch transition. Dave and his wife are involved in their family farm in Northeast Nebraska which they rent to two young beginning farmers.

Jim Habana Hafner joined Land For Good in 2013 and became Executive Director in 2015. A native of western Massachusetts, Jim worked summers on local farms. He has over 20 years' experience in program and fund development, outreach and research in international agriculture, community development, and public health. He has worked with farmers, NGOs and researchers on land tenure, conservation farming, agro-forestry and watershed management, especially in the Global South. Jim has graduate degrees in International Agriculture (M.S.) from UC Davis and Natural Resources (Ph.D.) from Cornell University.

David Haight is New York State Director at American Farmland Trust. He has helped coordinate major initiatives to help farmers protect healthy soil and clean wa-

ter on Long Island and in the Lake Ontario Watershed, scale up sales of local food to schools, colleges and other institutions in NY and facilitate the successful transition of farms to a new generation in New York's Hudson Valley. David and his wife, Suzanne, live with their two children in Malta, NY, and are proud owners of Balet Flowers & Design, a flower farm Y

Prof. Neil D. Hamilton is Director of the Agricultural Law Center at Drake University Law School in Des Moines. Since 1983, Neil has lead its research, education and extension on food policy, agricultural law and rural development. Past-president of the American Agricultural Law Association, Neil has authored books and articles on such topics as food democracy, rural lands, sustainable agricultural land tenure, and production contracts. He has conducted legal seminars throughout the U.S. and in 24 countries. In 2016 he co-chaired USDA's Subcommittee on Land Tenure. He has a B.S. from Iowa State, and a J.D. from Iowa. He and his wife Khanh own Sunstead Farm near Waukee.

Alicia Harvey is Farm Aid's Advocacy & Issues Director, where she guides advocacy, research, issues analysis and policy related activities to advance Farm Aid's mission and goals. She received her masters degree in Agricultural & Environmental Science and Policy from the Tufts Friedman School of Nutrition Science and Policy, where she also conducted research into U.S. farm household economics with the Global Development and Environment Institute at Tufts. Prior to Farm Aid, Alicia worked at Oxfam America's domestic program. Alicia grew up in Downingtown, Pennsylvania, with the state's beautiful rural landscape at her fingertips.

Jennifer Hashley is Director of the New Entry Sustainable Farming Project, a beginning farmer training program that assists diverse individuals to begin farming in Massachusetts. Jennifer is also a vegetable and pasture-based livestock farmer and serves on the Boards of The Carrot Project and the Urban Farming Institute of Boston. She is a farm business planning instructor for Massachusetts Department of Agricultural Resources and is advisor to several regional food systems initiatives. She served as an agricultural Peace Corps Volunteer in Honduras and holds a Master's in Agricultural Policy from Tufts University and a BS in Environmental Science from Indiana University.

Joe Hawbaker represents farmers and ranchers in Nebraska, primarily in estate, business and succession planning, commercial transactions, debtor/creditor law, and administrative law. He also works as a con-

sultant to the Nebraska Farm Mediation Service, Nebraska Farm Hotline and Beginning Farmer Project of Legal Aid of Nebraska. Joe regularly conducts legal clinics and succession planning workshops for farmers and ranchers throughout the state. He is the author of numerous articles on topics of farm and ranch interest. Joe received his BA from Grinnell College and his JD from the University of Michigan Law School.

Debra Heleba works at the University of Vermont (UVM) Extension as a sustainable and organic agriculture program coordinator. She was a founding staff member of both the Vermont Women's Agricultural Network and UVM Center for Sustainable Agriculture where she developed beginning farmer programming, coordinated Land Link Vermont, and provided educational programs on farm succession. In 2008, she joined UVM Extension's Northwest Crops and Soils Team that conducts on-farm research and outreach on soil health and agronomic crops. She is also the Vermont state SARE coordinator, providing program outreach and professional development trainings on social sustainability and other sustainable agriculture topics.

Janie Simms Hipp, J.D., LL.M. (Chickasaw) is Founding Director of the Indigenous Food and Agriculture Initiative at the University Of Arkansas School Of Law. She is an enrolled member of the Chickasaw Nation. Prior to the Initiative, she served in the Obama Administration as Senior Advisor for Tribal Relations to Secretary Tom Vilsack, and as the National Program Leader for Farm Financial Management, Risk Management Education, Trade Adjustment Assistance, and the Beginning Farmer and Rancher Development Program within NIFA. She has been a licensed attorney in Oklahoma for over 30 years, specializing in food and agriculture law and Indian law.

Jillian Hishaw, Esq., LL.M., is Founder and Director of F.A.R.M.S., a legal and education non-profit that provides services to small farmers and rural youth in the Southeast. Hishaw has over a decade of local, state, federal, legal, and non-profit experience in agriculture, environmental and estate planning matters. Hishaw worked for the USDA Office of Assistant Secretary of Civil Rights. After leaving USDA, Ms. Hishaw provided legal assistance to small farmers in NC and Alabama during the settlement phase of Pigford and Keepseagle. Hishaw has a Biology degree from Tuskegee University and a Juris Doctorate and Legal Masters in Agricultural law from the University of Arkansas-Fayetteville.

Savi Horne is the Executive Director of the Land Loss Prevention Project, a nonprofit organization founded in 1982 by the North Carolina Association of Black Lawyers to curtail epidemic losses of Black-owned land and to provide legal support and assistance to all financially distressed and limited resource farmers and landowners in North Carolina. Horne develops agriculture policy initiatives to keep minority and limited resource farmers on the land. She specializes in minority agricultural issues, sustainable agriculture, food systems policy, and environmental justice policy. Horne received her B.A. in Urban Legal Studies from Central College in New York and her J.D. from Rutgers University.

Jon Jaffe was raised on a 60 cow dairy farm in upstate NY. Jon has worked for Farm Credit East for nearly 34 years as a loan officer, assistant branch manager, tax specialist, and farm business consultant, providing strategic business analysis, farm succession/estate planning, tax consulting, and other consulting services. Jon has spoken at many seminars on farm succession planning, labor management, farm business training and business plan preparation. With Land For Good, he co-taught the Farm Succession School. Jon serves on the Carrot Project Advisory Board, the Rhode Island Ag Council, Mass Flower Growers Board of Directors and Cape Cod Cranberry Growers Board of Directors.

Seth Jansen, is interim CEO at Poudre Valley Community Farms (PVCF) which is a vehicle for community-ownership of farmland. PVCF purchases threatened farmlands and then provides long-term (e.g., 20-30 year) leases to local food producers. This ownership model offers a land tenure option for this, and future, generations of farmers in our community. Seth has a background in engineering and sustainability consulting. He served as the President of the Board for a year-and-a-half during PVCF's formational period and now oversees PVCF's work to complete its first farmland acquisition.

Kendra Johnson is farmland access, conservation and stewardship consultant. She coordinated CA FarmLink's Central Valley programs for 5 years, helping farmers/ranchers and landowners with tenure, succession, and farm business and finance needs. Since 2012 she has served on FarmLink's board, and has consulted with a variety of groups including land trusts, National Young Farmers Coalition, Agrarian Trust, One Farm at a Time, and others. She has a BA from Macalester College, and a MS in Community Development from UC Davis where she researched agricultural conservation

easements and farmland access. Kendra lives on the Russian River with her husband and three children.

Joy Kirkpatrick has worked in University of Wisconsin Extension for 24 years. She began her Extension career as a county-based educator. In 2004, she became the Outreach Specialist for the University of Wisconsin's Center for Dairy Profitability. In this position she collaborates with colleagues to provide educational programs and information on farm succession planning. Kirkpatrick received both her BS and MS degrees from SIU-Carbondale. Kirkpatrick has extensive experiences facilitating farm succession discussions with farm businesses and farm families. She has written articles on retirement and succession planning for farmers and taught seminars throughout the US on farm succession facilitation.

Reggie Knox has been working on behalf of small farmers and sustainable agriculture for 28 years and joined California FarmLink in 2004 to help beginning and low-resource farmers access land and capital. He became executive director in 2011 and has facilitated the growth of FarmLink's loan fund, and the organization's emergence as a Community Development Financial Institution. FarmLink's land access program helps farmers find land, develop sound lease agreements, and partner with landowners to transition farms to the next generation. During his career Reggie has developed expertise in farming, organic production, ag policy, non-profit management, farmland lease, finance and ownership strategies.

Kip Kolesinskas is a consulting Conservation Scientist whose current projects include assisting agencies, NGO's, and private individuals with farmland protection, land access and affordability for new and beginning farmers, farmland restoration, and climate change adaptation strategies. He is a member of the CT Working Lands Alliance Steering Committee, and the Connecticut Council on Environmental Quality. Formerly with the USDA Natural Resources Conservation Service State Soil Scientist for Connecticut and Rhode Island, Kip worked extensively with farmers, educators, government and nonprofits to help them protect farmland and wetlands, and use soils information to make better informed land use decisions.

Professor Matt Lobley is a Director of the Land, Society & Policy Programme in the Politics Department, University of Exeter, UK. Much of his research has focused on farm household behavior. One of his main areas of research expertise is in the family life-cycle and

succession issues. With John Baker, Matt co-directs a collaborative international project (FARMTRANSFERS) exploring farm succession and retirement in a range of different social, economic and political contexts. He is co-editor of 'Keeping it in the family: International Perspectives on Succession and Retirement on Family Farms' and has spoken on farm succession at several international conferences.

Scott Marlow is the Executive Director of the Rural Advancement Foundation International - USA, based in Pittsboro, NC. Scott previously directed RAFI's Farm Sustainability program, providing in-depth financial counseling to farmers in crisis, education on disaster assistance programs and access to credit, and the needs of mid-scale farmers who are increasing the sustainability of their farms by transitioning to higher-value specialty markets. Scott's specialty is financial infrastructure, including access to credit and risk management, and effect on food security and global climate change. He has a Masters Degree in Crop Science from NC State University, and a BA in Political Science from Duke University.

Andrew Marshall is Education and Field Director at Land For Good. Andrew spent 10 years as Educational Programs Director at the Maine Organic Farmers and Gardeners Association (MOFGA), where he oversaw the development of their innovative and nationally recognized farmer education programs. Andrew has a background in Agroecology and Rural Sociology, and holds degrees from Bowdoin College and the University of California, Santa Cruz. Andrew is also a farmer. He and his family operate Dorolenna Farm in Montville, Maine, where they produce certified organic vegetables, tree fruit, and poultry.

Dr. Maria Marshall is Professor in the Department of Agricultural Economics at Purdue University and Director of the Purdue Initiative for Family Firms. Dr. Maria Marshall has a nationally and internationally recognized integrated Extension, research, and teaching program focused on small and family business development. Her program thrust is to increase the viability and sustainability of small and family businesses as they develop and mature through their life cycles. Her research provides relevant information and publications to entrepreneurs, family business owners, and policy makers. She received a Ph.D. in agricultural economics from Kansas State University.

Gary Matteson works for Farm Credit's trade association in Washington, DC as Vice President, Young, Be-

ginning, Small Farmer Programs and Outreach. This includes policy work on local foods, sustainable agriculture, and direct-to-consumer agriculture. He frequently speaks to beginning farmers, training on basic financial skills and recordkeeping. For thirty years Gary was a small farmer raising greenhouse wholesale cut flowers marketed in the Northeast and beef cattle for local sales. He has served on numerous boards of directors including Farm Credit, the Boston Flower Exchange, and many non-profits.

Growing up, **Nellie McAdams** spent every weekend at her family's hazelnut farm in Gaston, Oregon. She followed in her father's footsteps as farm successor and attorney. As Farm Preservation Program Director at the Oregon nonprofit Rogue Farm Corps, Nellie helps develop and promote resources for farm succession planning and farmland preservation. In that role, she co-wrote a report, The Future of Oregon's Farmland, with OSU and PSU. She also wrote a gap analysis for the Coalition of Oregon Land Trusts on working lands easement holders in the state and is currently working with a coalition on related state policy.

Lilia McFarland is the New and Beginning Farmer and Rancher Program Coordinator for the Department of Agriculture. In this role, she works across USDA to ensure that the programs and services that USDA offers meet the needs of the next generation of agriculture. Lilia previously served as the Acting Chief of Staff for Agriculture Deputy Secretary, and in the office of the senior senator from California, focused on the farm bill and agriculture appropriations. Originally from Deep East Texas, Lilia earned her degree from the University of Texas in Austin.

Ian McSweeney is a leader in farmland conservation, transfer and tenure. As Director of the Russell Foundation, Ian supports sustainable farms by assisting landowners and farmers through a customized approach to permanent land protection, farm transfer, and sustainable ecologically diverse management. As a Board member of Agrarian Trust, Ian engages in farmland transfer, access and tenure on a national scale. Life experiences deeply root Ian's focus towards the protection of farmland and support for sustainable farms. Ian works with individuals and organizations on all levels; including farmers, farmland owners, zoning, conservation, planning and agricultural Boards, Commissions, and Districts, University Extension, USDA/NRCS.

Scott Miller is a Colorado native graduating from Colorado State University with a degree in Animal Science.

Scott has worked for the Farm Service Agency for over 32 years as a Loan Officer, Loan Specialist, and now as the Farm Loan Chief. Scott has worked in several County Offices throughout Colorado. He now works in the Colorado State Office as the Farm Loan Chief. Scott has worked with many Ag Lenders and Farm Producers around the state, making FSA loan programs work for them. Scott enjoys the outdoors and you can usually find him running, biking, hiking, or camping.

Maria Moreira is co-founder Executive Director of World Farmers Inc., (WF) a former dairy farmer, cheese maker, Extension Educator and a Mentor Farmer. An immigrant farmer herself, she's been mentoring beginning farmers since 1984. She directs the Flats Mentor Farm a program of World Farmers serving over 250 Immigrant Refugee. She is affiliated with and serves on the FSA County Committee, the USDA Beginning Farmers and Ranchers Advisory Committee, the Massachusetts Farm Bureau, 4-H, NIFI, Rural Coalition/Coalición Rural, NSAC, the Lancaster Agriculture commission, the Worcester County Food Hub. She has four children and four grandchildren. She lives with her family in Lancaster MA.

Matt Mulder is the Director of Operations for the Arcadia Center for Sustainable Food & Agriculture in Alexandria, VA. Matt has spent the last 19 years working on environmental and agricultural programs in the Washington, DC nonprofit community. Prior to Arcadia, he was the founding Director of the Accokeek Foundation's Center for Agricultural and Environmental Stewardship. He has spent the last decade working on programs to support new and beginning farmers with a focus on underserved communities. In 2015, he helped to create and launch Arcadia's Veteran Farmer Program, which prepares military veterans for new careers in agriculture.

Rachel Murray is the Connecticut Field Agent at Land For Good. Rachel's first high school job at a small fruit and vegetable farm in Western Connecticut had a profound impact on her decision to pursue Agriculture and Natural Resources at the University of Connecticut and afterwards pursue a Masters in Sustainable Food Systems from Green Mountain College in Poultney, VT. As a land-seeking farmer in Connecticut, Rachel understands the challenges and hurdles many farm seekers face in New England. Currently, she is production manager at Sunny Meadow Farm.

Kim Niewolny is an Associate Professor in the Department of Agricultural, Leadership and Community

Education at Virginia Tech. Her work centers on the role of power and equity in community education and development with a focus on social justice and food systems. This scholarship is grounded in asset-based community development; critical pedagogy, action research; and narrative inquiry. Current funded initiatives emphasize participatory capability building, community food work, Appalachian community food security, new farmer sustainability, and farmworker care/dignity. Kim serves as the Director of the Virginia Beginning Farmer and Rancher Coalition and AgrAbility Virginia, two statewide programs addressing land access issues.

Juli Obudzinski is the Deputy Policy Director for the National Sustainable Agriculture Coalition, a national non-profit organization based in Washington, D.C. Since 2011, she has led the coalition's federal policy work related to beginning farmers – focusing on the complex issues of how to improve new farmer access to capital, land, markets, and crop insurance. Previously, Obudzinski worked at the U.S. Department of Agriculture and also at the Leopold Center for Sustainable Agriculture helping to develop a statewide local food policy platform. Obudzinski currently serves on the USDA Advisory Committee on Agricultural Statistics, and holds degrees from the University of Wisconsin and Tufts University.

Jim Oldham is Executive Director of Equity Trust, a small national non-profit that promotes alternative forms of land ownership—for farms, housing, and other critical resources—that balance the needs of individuals with the needs of their communities and the environment. For twenty-five years, Equity Trust has worked to preserve affordable working farms using shared-equity ownership based on the community land trust model for affordable housing, as well as affirmative agricultural easements. Equity Trust also runs a revolving loan fund that enables lenders and donors around the country to support local food systems, affordable housing and other community investments.

Teresa Opheim is Senior Fellow for Renewing the Countryside and for Practical Farmers of Iowa (PFI), focusing on farm transitions. She is a Minnesota Institute for Sustainable Agriculture Endowed Chair for this work. She is a board member of Iroquois Valley Farms, a private company that works to get farmland to the next generation, and leads its USDA-funded conservation finance project. Teresa is the editor of *The Future of Family Farms* (University of Iowa Press 2016). She served as the Executive Director of PFI (2006-2016)

and has journalism and law degrees from the University of Iowa. Teresa and her family reside in Minneapolis.

Les Owen is the Conservation Services Director with the Colorado Department of Agriculture. His primary duties are engaging the department in federal land issues that impact agriculture. He recently moved here from New Mexico where he worked for New Mexico Department of Agriculture for the last 10 years on a variety of issues related to federal land management, threatened and endangered species, and other rules and regulations that affect natural resource management. He was raised near the small town of Corona, New Mexico where most of his time was spent working on the family ranch.

Sarah Parmar is Director of Conservation for Colorado Open Lands, a statewide land trust that works to permanently protect working farms and ranches using conservation easements. Sarah guides conservation prioritization, transactions, and partnerships and is responsible for the protection of 80,000 acres of private land in Colorado. Sarah has led research on the role of land trusts in generating alternatives to meeting water demand that do not dry up Colorado's productive farms. Her educational background is in agriculture and resource economics and she was the sixth generation to be raised on her family's cow calf operation in Southern Arizona.

Peg Petrzelka is Professor of Sociology at Utah State University. Her research focuses on the interrelationships between the physical and social environment in various settings. Since 2013 she has worked with American Farmland Trust researching non-operating landowners of agricultural land—a group whose voice has been invisible to both researchers and natural resource agencies. Current efforts are concentrated in the Great Lakes Region of the U.S., focusing on what incentives and barriers exist for these landowners (in particular women landowners), and their operators, with the goal of developing and implementing a project that results in improved conservation practices on the land.

Benneth Phelps joined Dirt Capital Partners in 2016 as the Director of Farmer Services to develop and refine the company's approach to investing in land in partnership with farmers. Previously, Benneth was Loan and Business Assistance Manager at The Carrot Project, where she spent five years evaluating loan applications and working with farm and food enterprises to plan for business growth. Prior to this she farmed

organic vegetables and small fruit in the Northeast. She holds an MRP in community and regional planning from the University of Massachusetts, and a BA from Smith College in American Studies and Economics.

James F. (Jim) Radintz is the Deputy Administrator for Farm Loan Programs in the USDA's Farm Service Agency (FSA). He is responsible for leadership, management and direction of FSA's direct and guaranteed lending programs. This includes over \$6 billion in new loans annually and a \$24 billion loan portfolio. Radintz grew up on a family farm in Iredell County, North Carolina, graduated summa cum laude with a B.S. in agriculture from NC State University, and received an MBA in finance from Virginia Tech. Radintz's 37-year federal career includes service in USDA field offices, and over 25 years in leadership positions at USDA headquarters.

Monica Ränge, B.S., J.D., LL.M., has worked in the public and private agricultural sectors for over 20 years, and is licensed to practice law in Florida. Experienced in agricultural policy development and program management, she serves as the Florida State Coordinator for the Federation of Southern Cooperatives/Land Assistance Fund. She manages regional USDA projects focusing on outreach and technical assistance to socially disadvantaged farmers and ranchers and rural sustainability. She serves as a board member for the Farmer Legal Action Group. She frequently advocates and lectures nationally on food security issues and the preservation of agricultural land rights in the South.

Kristine Ranger, M.Ed. has spent her professional career educating others about food and farming— from teaching agri-science to speaking, coaching and developing innovative solutions for farmers of all sizes and types. She has led a "Buy Local" campaign that increased sales of fresh Michigan products by 100%; consulted with agri-preneurs in human resources, business planning and marketing initiatives; facilitated sales and management workshops; and coached farm families through succession planning. As an Organizational Practitioner, she addresses the soft skills with hard core strategies to increase employee engagement and retention, build effective and cohesive leadership teams, improve organizational health and achieve transformational change.

Kathay Rennels, Associate Vice President for Engagement at Colorado State University, works to advance collaborative networks across the state and create economic development opportunities. She has significant experience fostering public and private partner-

ships in regional and rural workforce development, with particular attention to Larimer and Weld Counties. Rennels previously served three terms as a Larimer County Commissioner and is now leading the Food and Agriculture Key Industry Network for the State of Colorado. She helped initiate the 2013 “Value Chain of Colorado Agriculture” study, and co-authored the November 2014 follow-up study, “The Emergence of an Innovation Cluster in the Agricultural Value Chain along Colorado’s Front Range.”

Holly Rippon-Butler is the Land Access Program Director with the National Young Farmers Coalition, where she works with policy makers and land trusts to increase land access opportunities for the next generation of farmers. She has co-authored a guidebook for farmers on the process of partnering with a land trust to access land and organized trainings across the country on innovative conservation tools that help protect farmland affordability for farmers. In addition to her work with NYFC, she farms with her parents on their third-generation dairy and beef farm in Upstate New York.

Johanna Rosen works with Equity Trust’s Farms for Farmers Program, leading the urban agriculture initiative and helping farmers gain affordable access to farmland. Jo also works as the Communications Coordinator with Food Solutions New England. She co-founded and was Director of the Mill Creek Farm, a non-profit educational farm in Philadelphia.

Greg Rosenberg has a consulting practice in affordable and sustainable housing development, cohousing, urban agriculture, and community land trusts (CLTs). A founder of the National CLT Network and the CLT Academy, Greg served as the first Academy Director through 2011. Prior to the CLT Network, he was the Executive Director of the Madison Area CLT, where he developed Troy Gardens, an urban ecovillage project featuring a working farm, community gardens, a restored prairie, and a 30-unit mixed-income cohousing project. Greg collaborates with John Emmeus Davis on www.cltroots.org (an archive of the CLT movement), is licensed to practice law in the state of Wisconsin.

Kathryn Ruhf co-founded Land For Good as a 501(c)(3) specializing in farm access, tenure and transfer in 2004, and served as co-principle and then executive director until 2015. Now Senior Program Director, Ruhf oversees LFG’s program areas, including two USDA-funded Land Access Projects. Ruhf directed the New England Small Farm Institute (1987-2004) and

served on the USDA Beginning Farmer and Rancher Advisory Committee for 6 years. Ruhf has written, consulted and taught about beginning farmers, land tenure and food systems for 30 years. She holds a M.Ed. from University of MA and an M.S. from Antioch/New England. Ruhf lives in western Massachusetts.

Matt Russell is Resilient Agriculture Coordinator at Drake University Agricultural Law Center. He has worked on retail agriculture, land tenure, conservation, climate change, farmer veterans, rural development, state food policy, and federal farm policy. Matt is a fifth generation Iowa farmer. He and his husband Patrick Standley operate Coyote Run Farm and market produce, eggs, and beef. He serves on the Iowa Farm Service Agency State Committee. Matt received his B.A. from Loras College in Dubuque, studied for the Catholic Diocese of Des Moines at Mundelein Seminary in Illinois, and earned an M.S. in Rural Sociology from Iowa State University.

Michael Sands is the owner/operator of Bean Hollow Grassfed, a pasture-based farm raising sheep and cattle in Virginia. Currently Senior Associate of the Liberty Prairie Foundation (LPF), he served as founding Executive Director. This small private operating foundation, based in IL, is dedicated to the integration of economically prosperous, ecologically sensitive farms and high quality natural areas into vibrant working landscapes. He founded the Farm Business Development Center, a business incubator for beginning organic farmers. As Environmental Team Leader at Prairie Crossing in Grayslake, IL. Mike provided leadership in the design and management of natural resources and farm lands in an innovative conservation community.

Madeline Schultz is Program Manager of Iowa State University Extension and Outreach Women in Agriculture. She is a former Co-Director of the Annie’s National Network Initiative for Educational Success where she helped educators in 36 states offer Annie’s Project and other farm and ranch business management education programs designed for women. Madeline is a family farmer who, after farming 20 years and raising five children all passionate about agriculture, earned Bachelor of Science degrees in Agribusiness and Economics in 2003 and the Master of Business Administration degree with an interest in Sustainable Agriculture in 2007 from Iowa State University.

Liya Schwartzman has been working with farmers on behalf of California FarmLink since 2010. She has supported hundreds of farmers and ranchers in accessing

land, securing strong tenure agreements, exploring financing, and facilitating farmland and business succession plans. She is a frequent speaker at workshops and conferences on topics of importance to beginning and retiring farmers and ranchers. Liya was born and raised in the suburbs of Los Angeles, and graduated from UC Davis with a B.A. in Nature and Culture. She now resides in America’s Farm-to-Fork Capital, Sacramento, and enjoys all the fruits and vegetables that California has to offer.

Shirley Sherrod serves as Executive Director of the Southwest Georgia Project for Community Education, Inc., and the Vice President for Development for New Communities, Inc. In 2010, Sherrod was forced to resign her position as Georgia State Director of USDA Rural Development after a conservative blogger claimed she racially discriminated against a white farmer. The video set off a storm of controversy and criticism that led to Sherrod being asked to resign. Subsequent events led to USDA apologizing and offering her another job, which she declined. During the 1960’s Shirley and her husband helped to form New Communities, Inc. which acquired 6,000 acres of land as the first Community Land Trust in the US. Sherrod went on to work for the Federation of Southern Cooperatives in 1985 to help black farmers keep their land. Sherrod earned a Master’s Degree in Community Development from Antioch University in 1989. She also holds an honorary Doctorate of Humane Letters from Sojourner-Douglass College in Baltimore Maryland.

Andrew V. “Andy” Sorrell studied environmental planning and public administration at Virginia and worked for rural Virginia local governments as a county planner managing governmental programs and solving problems. Andy has managed the Office of Farmland Preservation at the Virginia Department of Agriculture and Consumer Services since 2013. At VDACS he works to keep land in active agricultural use connecting local governments, farmers, and others to resources that preserve farm land. Andy manages the Virginia Farm Link and Virginia Century Farm programs. Passionate about rural Virginia, Andy has served on the Executive Board of the Virginia Rural Planning Caucus since 2008.

Cris Stainbrook, a Lakota, is President of the Indian Land Tenure Foundation (ILTF) which provides grants and services to Indian nations and individual Indian people focused on recovering land within reservation boundaries and off-reservation sacred sites to Indian ownership and management. He is chairman of the

Indian Land Capital Company, a for-profit, CDFI subsidiary of ILTF and also board chair of the Native Governance Center. Mr. Stainbrook has worked on Indian land issues and economic development for more than 30 years. He and his wife operate Heath Glen Farm and Kitchen in Forest Lake.

Dustin Stein is the General Manager of Stubborn Farm and Burk Beef in Mancos, CO. He cut his teeth growing diversified produce on leased land and founded Stubborn Farm. In 2012 he joined forces with Jack and Patricia Burk at Burk Ranch (dba Burk Beef). He has since focused his efforts on their cattle: producing high quality, grass fed and finished beef. Dustin is concerned with producing the best beef possible while simultaneously improving the quality of the soil and water he relies on. Agricultural land conservation, transition, and maintaining access to irrigable land are issues that Dustin will always fight for.

Karen Stettler, Farm Beginnings Program Organizer for MN’s Land Stewardship Project has focused on beginning farmer land access for the past seven years of her 20 year tenure with LSP. Prior, Karen facilitated Farm Beginnings Courses working directly with hundreds of beginning farmers. Karen works with a local committee of farmers and a retired banker to develop workshops, services and networks aimed at facilitating farm transitions and beginning farmer land access as well as addressing needed systemic changes. Karen recently returned to her family farm where the 4th, 5th, and 6th generations live and farm together.

Harrison Topp is the Membership Director for the Rocky Mountain Farmers Union and the operator of Topp Fruits in Paonia, CO. He works with a diverse spectrum of farmers and ranchers in Wyoming, Colorado, and New Mexico to build community driven chapters and organize around local, state, and federal issues that impact agriculture. He is a first generation farmer, who began farming after college on a sugar farm in North Carolina. A native of Colorado, he graduated from New York University in 2009 with a double major in Film and Television Production and Anthropology.

Jeff Tranel is an Agricultural and Business Management Economist with Colorado State University Extension and Department of Ag and Resource Economics. His professional interests focus primarily in financial management, risk management, income tax management, human resources, business succession, estate planning, and end-of-life issues. He currently sits on the National Farm Income Tax Task Force. Jeff was

Presenters & Moderators

raised on a large commercial and purebred beef cattle ranch in south central Wyoming and northwestern Colorado. He now lives in Pueblo, CO with his wife Vanessa – CSU Extension’s military liaison. They have two adult sons.

Julia Valliant is a researcher with The Ostrom Workshop of Indiana University. She is focused on learning from farmers about their ideas for incentives for them to raise food products, biomass, and biodiversity. Current study (presented here) learns from programs and policies in the Midwest and Plains that aim to assist with farm and ranch transfers to an aspiring farmer. Other key words: farmer-led health movements, historical ties between animal agriculture and public health, grazing management and surface water quality, and documentary radio production. Doctoral training in Public Health was with the Johns Hopkins University Center for a Livable Future.

Jennifer Tucker Visitacion is the Executive Director of Guidestone Colorado, a nonprofit dedicated to growing a vibrant agricultural future through education, community building and partnerships. Guidestone Colorado manages Colorado Land Link, a program that supports land access and farm succession through connecting farmers to resources and opportunities and deepening the networks of support. With a background in natural resources, business and leadership development, Jen provides strategic planning and business coaching support to farmers, farm businesses and food systems organizations. Jen lives in Salida, CO with her family on their family operated farm, Moonstone Farm & Retreat Center.

Bob Wagner has worked in farmland protection and farm advocacy since 1981. Through numerous positions with American Farmland Trust and earlier as a legislative assistant to then-Congressman James Jeffords of Vermont and a consultant to the Vermont Department of Agriculture, Bob has played an active role in the promotion and development of state and local farmland protection strategies and programs throughout the country. Since retiring from AFT in 2016, he has consulted on various farming and farmland projects for Land For Good, Equity Trust, Vermont Land Trust and AFT. Bob chairs the Agricultural Advisory Commission, Community Preservation Committee and Planning Board in Hatfield, MA.

Sarah Wentzel-Fisher, the executive director of the Quivira Coalition, has worked in food and agriculture planning for the past seven years with a focus on young

and beginning farmers and ranchers. In addition, she is the board president of the Rio Grande Agricultural Land Trust. She was the editor of Edible Santa Fe from 2011 to 2017 and from 2013 to 2015 she worked as an organizer for the National Young Farmers Coalition. In her free time she enjoys visiting farms and ranches, helping new agrarians find their career paths, experimenting in her kitchen, and keeping chickens in her backyard.

Pete Westover is Senior Partner in Conservation Works, LLC, a Massachusetts firm specializing in agricultural land protection, farm viability assistance, conservation and forestry land management, ecological studies, and open space planning. For many years he has also provided technical support for local Agricultural Commissions in Massachusetts for the MA Dept. of Agricultural Resources. He is an adjunct professor at Hampshire College in Amherst, MA, currently teaching a course in Indigenous Land Rights. He is also a Massachusetts Board member of the Conservation Law Foundation and a member of the Five College Native American and Indigenous Studies Certificate Program.

Jean Willoughby is an aspiring farmer on the lookout for the “gift of good land.” She currently lives on two rented acres and primarily grows culinary and medicinal herbs. She is author of Nature’s Remedies: An Illustrated Guide to Healing Herbs (Chronicle Books, 2016) and gained certification through the Herbal Academy of New England. Jean has worked for the Rural Advancement Foundation International for five years, overseeing the Agricultural Reinvestment Fund, a grant program for innovative and entrepreneurial small farmers, and she currently serves as the organization’s Communications Manager. Jean also serves on the Board of Directors of Agrarian Trust.

As the owner and operator of JSM Organics, **Javier Zamora** cultivates over 30 acres of strawberries and unique varieties of vegetables and flowers in Royal Oaks and Aromas, CA. He earned his landscaping degree from San Joaquin Delta College and his organic production degree from Cabrillo College. Javier trained at the Agriculture & Land-Based Training Association (ALBA) in Salinas. Javier helps other farmers and educates the community about sustainable farming practices. He hosts workshops designed to train agricultural professionals and aspiring and beginning farmers about sustainable agriculture and conservation practices.

Attendees

FIRST	LAST	AFFILIATION	POSITION	REGION	EMAIL
Nathan	Aaberg	Liberty Prairie Foundation	Director, Conservation & Working Lands	IL	nathan@libertyprairie.org
Tom	Abood	Local Matters Investments	Member	CO	tabood@comcast.net
Edoe	Agbodjan	SC State University 1890 Research and Extension	Senior Extension Director	SC	eagbodjan@scsu.edu
Mary Clare	Ahearn	ERS, retired	Senior Economic Consultant	FL	mahearn54@aol.com
Wren	Almitra	Women, Food & Agriculture Network	Program Coordinator	IA	wren@wfan.org
Danielle	Ardrey	Colorado State University Extension, Arapahoe County	Program Coordinator	CO	dardrey@arapahoegov.com
Misti	Arias	Sonoma County Agricultural Preservation and Open Space District	Acquisition Program Manager	CA	misti.arias@sonoma-county.org
Sanaz	Arjomand	American Farmland Trust	Government Affairs Specialist	DC	sarjomand@farmland.org
David	Baker	Iowa State University	Farm Mgmt. Field Specialist	IA	baker@iastate.edu
John	Baker	International Farm Transition Network	Chair	IA	jrbaker@iastate.edu
Becky	Balk	Minnesota Department of Agriculture	Beginning & Transitioning Farming Coordinator	MN	becky.balk@state.mn.us
Jody	Barbour	Conservation Tax Credit Transfer	Owner	CO	jody@taxtransfer.net
Amanda	Barker	Colorado Coalition of Land Trusts	Executive Director	CO	amanda.barker@cclt.org
Jon	Beckner	Agriburbia	Land Acquisitions & Development	VA	jbeckner@agriburbia.com
Amy	Beres	Rocky Mountain Farmers Union	Assistant Director, Urban Cooperative Development	CO	amy.beres@rmfu.org
John	Berry	Penn State Extension	Educator	PA	johnberry@psu.edu
Chris	Beyerhelm	U.S. Department of Agriculture, Farm Service Agency	Acting Administrator	DC	chris.beyerhelm@wdc.usda.gov
Tim	Biello	American Farmland Trust	Hudson Valley Farmlink Network Coordinator	NY	tbiello@farmland.org
Daniel	Bigelow	USDA-Economic Research Service	Research Agricultural Economist	DC	daniel.bigelow@ers.usda.gov
Peggy	Bill	San Juan County Agricultural Resources Committee	Coordinator	WA	peg@sjcarc.org
Adam	Bishop	Maine Farmland Trust	Director, Farmland Protection Program	ME	abishop@mainefarmlandtrust.org

Attendees

FIRST	LAST	AFFILIATION	POSITION	REGION	EMAIL
Laura	Bozzi	Southside Community Land Trust	Director of Programs	RI	laura.bozzi@gmail.com
Andrew	Branan	The Branan Law Firm, PLLC		NC	andrew@brananlaw.com
Kindra	Brandner	USDA NRCS	EQIP Program Specialist	CO	kindra.brandner@co.usda.gov
Emy	Brawley	Openlands	Vice President of Conservation	IL	ebrawley@openlands.org
Sara	Bray	Bray Ranches		CO	saralbray@hotmail.com
Zandon	Bray	Bray Ranches		CO	zandon@brayranches.com
Don	Brown	Colorado Department of Agriculture	Commissioner	CO	karen.lover@state.co.us
Tess	Brown-Lavoie	Land For Good	RI Field Agent	RI	tess@landforgood.org
Karen	Burke	Sisters of St. Joseph	Coordinator of Land Initiatives	NY	kburke105@msn.com
Erica	Buswell	Maine Farmland Trust	Vice President of Programs	ME	ebuswell@mainefarmlandtrust.org
Deborah	Cantrell	University of Colorado Law	Associate Professor & Director of Clinical Education Program	CO	deborah.cantrell@colorado.edu
Adrian	Card	Colorado State University Extension	Agriculture Agent	CO	adrian.card@colostate.edu
Cara	Cargill	Land For Good	NH Field Agent	NH	cara@landforgood.org
Stephen	Carpenter	Farmers' Legal Action Group, Inc. (FLAG)	Attorney & Deputy Director	MN	scarpenter@flaginc.org
Caleb	Carter	University of Wyoming Extension	Extension Area Educator	WY	ccarte13@uwyo.edu
Jake	Carter	Austin/Travis County Food Policy Board	Co-chair, Farmland Preservation & Access working group	TX	jake@jakejive.com
Aaron	Clay	Clay and Dodson P.C.	President	CO	aaronclay@qwestoffice.net
Cris	Coffin	Land For Good	Policy Director	NH	cris@landforgood.org
Brian	Coppom	Boulder County Farmers Markets	Executive Director	CO	director@bcfm.org
Jerry	Cosgrove	American Farmland Trust	Senior Advisor	NY	jcosgrove@farmland.org
James	Craig	AgrAbility	Rural Rehabilitaiton Veterans Issues	CO	jcraig@goodwilldenver.org
Charles	Curtin	Colorado Headwaters Land Trust	Executive Director	CO	ccurtin@earthlink.net
Laura	Cutlip	Pitkin County OST	Stewardship Intern	CO	laura.cutlip@coloradocollege.edu
Siddhartha	Dasgupta	Kentucky State University	Professor	KY	siddhartha.dasgupta@kysu.edu
Poppy	Davis	C2C Consulting	Consultant	CA	occidentalpoppy@outlook.com

Attendees

FIRST	LAST	AFFILIATION	POSITION	REGION	EMAIL
Jennifer	Dempsey	American Farmland Trust	Director, Farmland Information Center	MA	jdempsey@farmland.org
Suzanna	Denison	WNC FarmLink	Director	NC	info@wncfarmlink.org
Colette	DePhelps	University of Idaho Extension	Area Extension Educator Community Food Systems	ID	cdephelps@uidaho.edu
Lauren	Dixon	Benevolent Investors Guide		CA	laurenabf@gmail.com
Beth	Dooley	International Farm Transition Network	Executive Director	IA	farmtransition@gmail.com
Thomas	Driscoll	National Farmers Union Foundation	Director	DC	tdriscoll@nfdc.org
Paul	Durrenberger	Sustainable Iowa Land Trust (SILT)	Board Member	IA	epd2@psu.edu
Tracy	Emrick	Cuyahoga Valley Countryside Consernavcy	Executive Director	OH	temrick@cvcountryside.org
Reba	Epler	Accomplished ranch hand.		WY	rebaepler@icloud.com
Suzan	Erem	Sustainable Iowa Land Trust	President	IA	suzan@silt.org
Kenny	Fahey	The Conservation Fund		WA	kfahey@conservationfund.org
Jon	Fenton	Agriburbia		CO	
Theodosia	Ferguson	Healing Living Systems, Inc.	Founder, CEO	CA	theo@healinglivingsystems.org
Wyatt	Fraas	Center for Rural Affairs	Project Manager	NE	wyattf@cfra.org
Julia	Freedgood	American Farmland Trust	Assistant Vice President, Programs	MA	jfreedgood@farmland.org
Mary	Fund	Kansas Rural Center	Executive Director	KS	mfund@kansasaruralcenter.org
Heather	Gessner	SDSU Extension	Livestock Business Management Field Specialist	SD	heather.gessner@sdstate.edu
Mike	Ghia	Land For Good	VT Field Agent	VT	mike@landforgood.org
Josh	Giuntoli	Washington State Conservation Commission	Program Coordinator, Office of Farmland Preservation	WA	jgiuntoli@scc.wa.gov
Liz	Gleason	Vermont Farm Viability Program		VT	liz@vhcb.org
Dave	Goeller	University of Nebraska	Transition Specialist (Retired)	NE	dgoeller28@gmail.com
Kate	Graham	Maser, Amundson, Boggio & Hendricks, PA	Attorney	MN	kgraham@maserlaw.com
Reuben	Gregory	SFPC		CO	reubengregory@me.com
Ariga	Grigoryan	UW Extension Sawyer County and Lac Courte Oreilles Tribe	Community, Natural Resources & Economic Development	WI	ariga.grigoryan@ces.uwex.edu

Attendees

FIRST	LAST	AFFILIATION	POSITION	REGION	EMAIL
Jim	Hafner	Land For Good	Executive Director	NH	jim@landforgood.org
David	Haight	American Farmland Trust	New York State Director	NY	newyork@farmland.org
Ella	Haley	Langford Conservancy	Executive Director	ON, Canada	ehaley1@gmail.com
Neil	Hamilton	Drake University Agricultural Law Center	Professor & Director	IA	neil.hamilton@drake.edu
Eric	Hansen	Go Farm Hawai'i	Program Coordinator / Farm Coach (Kaua'i Island)	HI	ewhansen@hawaii.edu
David	Harper	Pee Dee Land Trust	Executive Director	SC	pdlt@peedeelandtrust.org
Jessica	Harrold	Ada Soil & Water Conservation District	Program Coordinator	ID	jessica.rae.harrold@gmail.com
Evelyn	Hartman	West Virginia Food & Farm Coalition	Community Relations Coordinator	WV	ehartman@wvfoodandfarm.org
Alicia	Harvie	Farm Aid	Advocacy & Issues Director	MA	alicia@farmaid.org
Jennifer	Hashley	New Entry Sustainable Farming Project	Director	MA	jennifer.hashley@tufts.edu
Joe	Hawbaker	Hawbaker Law Office	Attorney	NE	jmhawbaker@gmail.com
Debra	Heleba	University of Vermont Extension		VT	debra.heleba@uvm.edu
Kelly	Henderson	Ohio Ecological Food and Farm Association	Begin Farming Program Coordinator	OH	kelly@oeffa.org
Janie	Hipp	Indigenous Food & Agriculture Initiative, University of Arkansas School of Law	Director and Visiting Professor of Law	AR	jhipp@uark.edu
Jillian	Hishaw	Family Agriculture Resource Management Services	Founder/Director	SC	jhishaw@gmail.com
Michael	Hoffman	E. Michael Hoffman, P.C.	Attorney	CO	mhoffman@emhlaw.net
Paul	Holsinger	Pitkin County OST	Agriculture and Conservation Easement Administrator	CO	paul.holsinger@pitkincounty.com
Savonala "Savi"	Horne	North Carolina Association of Black Lawyers Land Loss Prevention Project	Executive Director	NC	savi@landloss.org
Jack	Hornickel	FARMroots, GrowNYC	Business Planning and Legal Specialist	NY	jhornickel@grownyc.org
Jonathan	Jaffe	Farm Credit East	Farm Business Consultant	CT	jon.jaffe@farmcrediteast.com
Seth	Jansen	Poudre Valley Community Farms	Interim CEO	CO	seth@farmland.coop
Megan	Jenny	PCC Farmland Trust	Community Engagement Manager	WA	megan.jenny@pccfarmlandtrust.org
Jan	Joannides	Renewing the Countryside	Executive Director	MN	jan@rtcinfo.org

Attendees

FIRST	LAST	AFFILIATION	POSITION	REGION	EMAIL
Kendra	Johnson	California FarmLink	Board Member	CA	kendramj@gmail.com
Suvia	Judd	Permaculture Conservation Trust		ID	letterfromtheland@gmail.com
Jenna	Keller	Keller Law, LLC	Attorney	CO	jkeller@kellerlawllc.com
Juanita	Kelley	Jane B. Fredman, LLC	Paralegal	CO	juanita@fredmanlawco.com
Jennifer	Kemp	Boulder County Parks & Open Space	Local Food & Public Outreach Specialist	CO	jkemp@bouldercounty.org
Tianna	Kennedy	The Center for Agricultural Development & Entrepreneurship	Vice Chair	NY	tianna.kennedy@gmail.com
Daphne	Kingsley	Light Root Community Farm	Farmer	CO	milkmaiddaphne@gmail.com
Joy	Kirkpatrick	UW Center for Dairy Profitability	Outreach Specialist	WI	joy.kirkpatrick@ces.uwex.edu
Stefanie	Kitchen	South Carolina Department of Agriculture		SC	skitchen@scda.sc.gov
Bob	Kjelland	Rocky Mountain Farmers Union	Director of Communications	CO	bob.kjelland@rmfu.org
Reggie	Knox	California FarmLink	Executive Director	CA	reggie@cafarmlink.org
Janette	Kochis	Rocky Mountain Farmers Union	Board Member	CO	jkochis@wildblue.net
Kip	Kolesinskas	American Farmland Trust	Consulting Conservation Scientist	CT	kip.kolesinskas@gmail.com
Joanna	Lehrman	The 11th Hour Project		CA	joanna@11thhourproject.org
Danielle	Levoit	Doris Duke Charitable Foundation	Program Officer, Environment	NY	dlevoit@ddcf.org
Alan	Lewis	Natural Grocers by Vitamin Cottage NYSE:NGVC	Food & Ag Policy	CO	alewis@naturalgrocers.com
Matt	Lobley	University of Exeter	Associate Professor in Rural Resource Management	U.K.	leep@exeter.ac.uk
Meighen	Lovelace	National Farmers Union	Intern	DC	meighen.lovelace@mountainharvest.org
Lisa	Luciani	Land For Good	Communications Coordinator	NH	lisa@landforgood.org
Michael	Lufkin	King County	Local Food Economy Manager	WA	michael.lufkin@kingcounty.gov
Lauren	Manning	University of Arkansas School of Law	Faculty	AR	laurenmanning9@gmail.com
Elizabeth	Manus		Writer	CO	e.manus@icloud.com
Scott	Marlow	The Rural Advancement Foundation International	Executive Director	NC	smarlow@rafusa.org
Maria	Marshall	Purdue University	Professor	IN	mimarsha@purdue.edu

Attendees

FIRST	LAST	AFFILIATION	POSITION	REGION	EMAIL
Andrew	Marshall	Land For Good	Education & Field Director	ME	andrew@landforgood.org
Gary	Matteson	Farm Credit	VP Young, Beginning, Small Farmer Programs	DC	matteson@fccouncil.com
Rosalind	May	Four Seasons Farmers and Artisans Market	Program Coordinator	CO	rosalind.may@zoho.com
Nellie	McAdams	Rogue Farm Corps	Farm Preservation Program Director	OR	nellie@roguefarmcorps.org
Dale	McCall	Rocky Mountain Farmers Union	Board President	CO	dale.mccall@rmfu.org
Lilia	McFarland	U.S. Department of Agriculture, Farm Service Agency	New and Beginning Farmer and Rancher Program Coordinator	DC	lilia.mcfarland@wdc.usda.gov
Judith	McGeary	Farm and Ranch Freedom Alliance	Executive Director	TX	judith@farmandranchfreedom.org
Sean	McGovern	USDA SARE Program	Outreach Manager	OH	smcgovern@sare.org
Kerry	McGrath	California FarmLink	North Coast Program Coordinator	CA	kerry@cafarmlink.org
Ian	McSweeney	Agrarian Trust	Board Member	NH	ian@russellfound.org
Rusty	Milholland	PCC Farmland Trust	Stewardship Manager	WA	rusty.milholland@pccfarmlandtrust.org
Edgar	Miller	Conservation Trust for NC	Director of Government Relations & Farmland Preservation	NC	edgar@ctnc.org
Scott	Miller	USDA - Farm Service Agency	Farm Loan Chief	CO	scott.miller@co.usda.gov
Wade	Miller	CROPP Cooperative	Farm Development Manager	WI	wade.miller@organicvalley.coop
Jackson	Moller	The Nature Conservancy	Land Protection Specialist	CO	jackson.moller@tnc.org
Maria	Moreira	World Farmers	Executive Director & Co-founder	MA	mmoreira@worldfarmers.org
Travis	Mountain	Virginia Tech	Assistant Professor	VA	travis35@vt.edu
Carolyn	Mugar	Farm Aid	Executive Director	MA	carolyn@farmaid.org
Matt	Mulder	Arcadia Center for Sustainable Food and Agriculture	Director of Operations	VA	matt@arcadiafood.org
Rachel	Murray	Land For Good	CT Field Agent	CT	rachel@landforgood.org
Kim	Niewolny	Virginia Tech	Associate Professor	VA	niewolny@vt.edu
Keeley	Nixon	FarmLINK.net		BC, Canada	keeley@farmlink.net
Bill	Nobles	WSARE/CSU Extension	Colorado WSARE Coordinator/CSU Extension Region Director	CO	william.nobles@colostate.edu

Attendees

FIRST	LAST	AFFILIATION	POSITION	REGION	EMAIL
Juli	Obudzinski	National Sustainable Agriculture Coalition	Deputy Policy Director	DC	jobudzinski@sustainableagriculture.net
Jim	Oldham	Equity Trust	Director	MA	jim@equitytrust.org
Patti	O'Neal	CSU Extension	Horticulturist/Urban Ag	CO	poneal@jeffco.us
Teresa	Opheim	Renewing the Countryside/Iroquois Valley Farms	Senior Fellow	IA	teresa@rtcinfo.org
Kathy	Orlando	Sheffield Land Trust	Executive Director, Land Protection	MA	shefland@bcn.net
Les	Owen	Colorado Department of Agriculture	Director, Conservation Services Division	CO	les.owen@state.co.us
Katie	Painter	Global Gardens	Program Manager	ID	kpainter@idahorefugees.org
Sarah	Parmar	Colorado Open Lands	Director of Conservation	CO	sparmar@coloradoopenlands.org
Gary	Peterson	California FarmLink	Director of Communications & Philanthropy	CA	gary@cafarmlink.org
Peggy	Petzelka	Utah State University	Professor of Sociology	UT	peggy.petzelka@usu.edu
Benneth	Phelps	Dirt Capital Partners	Director of Farmer Services	MA	benneth@dirtpartners.com
Greg	Plotkin	American Farmland Trust	Communications	DC	gplotkin@farmland.org
James	Radintz	USDA- Farm Service Agency	Deputy Administrator, Farm Loan Programs	DC	jim.radintz@wdc.usda.gov
Ben	Rainbolt	Rocky Mountain Farmers Union	Executive Director	CO	ben.rainbolt@rmfu.org
Monica	Rainge	Federation of Southern Cooperatives/ Land Assistance Fund	Director of Land Retention & Advocacy	GA	monicarainge@federation.coop
Kristine	Ranger	The Learning Connection		MI	kristine@knowledgenavigators.com
Quint	Redmond	Agriburbia	Owner, CEO	CO	qredmond@agriburbia.com
Dave	Renn	Community Food and Agriculture Coalition	Beginning Farmer and Rancher Program Manager	MT	dave@farmlinkmontana.org
Kathay	Rennels	Colorado State University		CO	kathay.rennels@colostate.edu
Laura	Rigan	GTRLC	Farmland Protection Specialist	MI	lrigan@gtrlc.org
Holly	Rippon-Butler	National Young Farmers Coalition	Land Access Program Director	NY	holly@youngfarmers.org
Cindy	Roberts	State of New Jersey - State Agriculture Development Committee	Presrvation Education Specialist	NJ	kendra.hall-perkins@ag.nj.state.us
Ross	Rodgers	Restore Colorado: Seeds for the People non-profit project of RMPJC	Founder & Program Director	CO	sacredlifeseeds@gmail.com

Attendees

FIRST	LAST	AFFILIATION	POSITION	REGION	EMAIL
Maria	Rojas	FARMroots, GrowNYC	Beginning Farmer Program Manager	NY	mrojas@grownyc.org
Charles	Roohr	State of New Jersey - State Agriculture Development Committee	Stewardship Manager	NJ	kendra.hall-perkins@ag.state.nj.us
Johnny	Roos	Turtle Island Ecology Center	Secretary	CO	johnroos07@hotmail.com
Johanna	Rosen	Equity Trust		MA	johanna@equitytrust.org
Greg	Rosenberg	Rosenberg & Associates		WI	greg@gregrosenberg.com
Kathryn	Ruhf	Land For Good	Senior Program Director	MA	kathy@landforgood.org
Matt	Russell	Drake University Agricultural Law Center	Resilient Agriculture Coordinator	IA	matt.russell@drake.edu
Ron	Saacke	Virginia Farm Bureau	Young Farmers Coordinator	VA	ron.saacke@vafb.com
Michael	Sands	Liberty Prairie Foundation	Senior Associate	VA	mike@libertyprairie.org
Madeline	Schultz	Iowa State University Extension and Outreach Women in Ag	Program Manager	IA	schultz@iastate.edu
Liya	Schwartzman	California FarmLink	Central Valley Program Coordinator	CA	liya@cafarmlink.org
Shirley	Sherrod	Southwest Georgia Project for Community Education, Inc.	Executive Director	GA	shirleymsherrod@gmail.com
Donald	Sienkiewicz	Estate Preservation & Planning Law Office		NH	dhs@estateplannh.com
Andrew	Sorrell	Virginia Department of Agriculture and Consumer Services	Coordinator, Office of Farmland Preservation	VA	andrew.sorrell@vdacs.virginia.gov
Cris	Stainbrook	Indian Land Tenure Foundation	President	MN	cstainbrook@iltf.org
Dustin	Stein	Stubborn Farm & Burk Beef	General Manager	CO	stubbornfarm@gmail.com
Karen	Stettler	Land Stewardship Project		MN	stettler@landstewardshipproject.org
Bill	Stevenson	Rocky Mountain Farmers Union	Director, RMFU Cooperative Development Center	CO	bill.stevenson@rmfu.org
Martha	Sullins	Colorado State University	Extension Specialist	CO	martha.sullins@colostate.edu
Kyle	Sulzen			CO	ksulzen@gmail.com
Amy	Swoboda	Legal Aid of Nebraska		NE	aswoboda@legalaidofnebraska.org
Brett	Sykes	Maine Farmland Trust	Farmland Protection Project Manager	ME	brett@mainefarmlandtrust.org
Andrew	Szwak	Openlands	Policy & Planning Analyst	IL	aszwak@openlands.org

Attendees

FIRST	LAST	AFFILIATION	POSITION	REGION	EMAIL
Cassidy	Tawse-Garcia	National Young Farmers Coalition	Southwest Organizer	CO	cassidy@youngfarmers.org
Don	Teske	National Farmers Union	Vice President	KS	dteske@nfudc.org
Neil	Thapar	Sustainable Economies Law Center	Food & Farmland Attorney	CA	neil@theselc.org
Lytanya	Toomer-Brown	Federation of Southern Cooperatives		MS	
Harrison	Topp	Rocky Mountain Farmers Union	Membership Director	CO	harrison.topp@rmfu.org
Jeffrey E	Tranel	Colorado State University	Agricultural & Business Management Economist	CO	jtranel@colostate.edu
Matthew	Treadwell	National FFA Foundation	Planned Giving Coordinator	IN	mtreadwell@ffa.org
Wesley	Tucker	University of Missouri Extension	Farm Management Specialist	MO	tuckerw@missouri.edu
Julia	Valliant	Indiana University	Researcher	IN	jdvd@indiana.edu
Jennifer	Visitacion	Guidestone Colorado	Executive Director	CO	jennifer@guidestonecolorado.org
Ronnica	Vitulo	Guidestone Colorado	AmeriCorps VISTA	CO	ronni@guidestonecolorado.org
Allan	Vyhnalek	Nebraska Extension	Extension Educator	NE	avyhnalek2@unl.edu
Robert	Wagner	Land for Good	Associate	MA	bwagner954@yahoo.com
Lucy	Waldo	Central Colorado Conservancy	Conservation Director	CO	lucy@centralcoloradoconservancy.org
Tahz Rufus	Walker	RAFI Rural Advancement Foundation International	Director, Come to the Table Project	NC	tahz@rafiusa.org
Emmett	Watson	Land for Good	Donor	NY	bluecoat1@gmail.com
Christopher	Wayne	FARMroots, GrowNYC	Director	NY	cwayne@grownyc.org
Amanda	Weaver	University of Colorado Denver	Senior Instructor	CO	amanda.weaver@ucdenver.edu
Sarah	Wentzel-Fisher	Quivira Coalition	Executive Director	NM	sarah@quiviracoalition.org
Pete	Westover	Conservation Works	Partner	MA	westover03@comcast.net
Jean	Willoughby	Agrarian Trust	Board of Directors	NC	jean@rafiusa.org
Nina	Young	Maine Farmland Trust	Farmland Protection Project Manager, Project Development Specialist	ME	nyoung@mainefarmlandtrust.org
Javier	Zamora	JSM Organics	Grower	CA	javszam@yahoo.com

Restaurants

Wednesday 6:00P | Dinner on the town

These farm-to-table and sustainable dining establishments are among many dining opportunities in Denver. Ask the hotel or look online for additional recommendations.

Beatrice & Woodsley

38 S Broadway, Denver
Woodsy, playful setting for New American small plates & innovative cocktails.

Duo

2413 W 32nd Ave, Denver
Creative local farm-to-fork New American cuisine in a warm, rustic, continually packed space.

Fruition Restaurant

1313 E 6th Ave, Denver
Tiny destination drawing foodies for chef Alex Seidel's refined farm-to-table New American cuisine.

Mercantile Dining & Provisions

1701 Wynkoop St #155, Denver
High-performance space includes a New American eatery, wine library, artisanal market & barista bar.

Old Major

3316 Tejon St, Denver
Rustic-chic restaurant specializing in elevated dishes from sustainable sources & top-shelf drinks.

The Kitchen

1530 16th St., Denver
(entrance on Wazee Street)
Garden-to-table American meals & a popular happy hour in an eco-friendly urban space.

Panzano

909 17th St, Denver
Posh yet still casual eatery in the Hotel Monaco focusing on sustainable Northern Italian cuisine.

Potager

1109 N Ogden St, Denver
Rustic dining room whose organic New American menu changes monthly to reflect what's market-fresh.

Root Down

1600 W 33rd Ave, Denver
A converted filling station is an artful, high-energy venue for creative American small plates.

Sazza

2500 E Orchard Rd, Greenwood Village
Bright counter-serve with thin-crust pizzas & salads that make use of local & organic ingredients.

The Squeaky Bean

1500 Wynkoop St #101, Denver
Eclectic, farm-driven menu in a brick space with an open kitchen, floor-to-ceiling windows & a bar.

Local Transportation

BY RAIL

The A Line runs from Central Park Station to downtown Denver every 15 minutes (less frequently during off hours). The ride is 14 minutes and costs \$2.60.

Please see the hotel front desk or Guest Services for details or visit: www3.rtd-denver.com/a-line.shtml

BY CAR

Parking at the hotel is complimentary. Parking downtown can be a hassle. Consider the train if you're heading into the city for dinner on Wednesday.



Soybeans look like prayers
bouncing off the ceiling

When the prices on the Chicago
grain market start to drop,

Or like your old man's tears
when you tell him

How much the land might bring
for subdivisions.

Thomas Alan Orr
SOYBEANS

After-dinner entertainment guaranteed to inspire you.

Movie Night

Tuesday 8:45P | Keystone 1

Homeplace Under Fire (30 min)

The Farm Crisis of the 1980s drove hundreds of thousands of family farmers into foreclosure. Yet, out of that crisis arose a legion of farm advocates who refused to stand idly by and watch their way of life be destroyed. As fellow farmers, farm wives, and rural leaders, they studied laws and regulations, started hotlines, answered farmers' calls from their kitchen tables, counseled their neighbors, and went toe-to-toe with lenders – giving their all to keep their neighbors on the land. Thousands of farmers are alive and on their land today because of them. This documentary by Farm Aid celebrates these advocates and their remarkable work.

Arc of Justice (20 min)

This award-winning documentary traces the remarkable journey of New Communities, Inc. (NCI) in southwest Georgia, a story of racial justice, community organizing, and perseverance. NCI was created in 1969 by Civil Rights leaders including Congressman John Lewis, and Charles and Shirley Sherrod (a conference presenter), to help secure economic independence for African American families. For 15 years, NCI cooperatively farmed nearly 6,000 acres, the largest tract of land in the US owned by African Americans at the time. In the face of racist attacks and discrimination, NCI lost the land to foreclosure in 1985. But 25 years later it was given new life.

Barber Farm Project (30 min)

The Barber Farm Project is a movie about what happened when a local film maker tried to save her grandmother's farm from development. The Barber Farm Project follows four generations of a Vermont farm family over more than a decade as they struggle to find a way to keep their land from being developed. The film addresses the intergenerational transfer of farms along with the challenges of being a small farmer, and the importance of building local food systems.



To view other related videos after the conference, visit:
landforgood.org/our-work/changing-lands-changing-hands

Readers Theater

Tuesday 8:45P | Keystone 2

Look Who's Knockin'

This unique one-act play by the Land Stewardship Project will be performed as a readers theatre. Written by LSP's, Doug Nopar, Look Who's Knockin' is based on the stories of farm families facing transition to the next generation. The play explores the dilemma faced by Nettie and Gerald, long-time conservation farmers. Should they sell their farm for top dollar to the largest cash grain farmer in the county? Or should they help a young farm couple enter dairying? After the performance we'll discuss how this play can be performed in your community to open up conversation around the challenging topic of farm transitions.



It is said that in the United
States we have free trade in
land. It can be bought and sold
at will. But there are certain
weaknesses in the system even
today.

Liberty Hyde Bailey

CYCLOPEDIA OF AMERICAN
AGRICULTURE, VOLUME IV,
CHAPTER V LAND AND LABOR, 1909

The decline in the percentage
of landowning farmers is due
largely to the fact that a longer
period is required to save the
money with which to buy a
farm. Hence, each succeeding
generation of farmers must
remain longer in the tenant
class.

Liberty Hyde Bailey

CYCLOPEDIA OF AMERICAN
AGRICULTURE, VOLUME IV,
CHAPTER V LAND AND LABOR, 1909

About Land For Good

Land For Good (LFG) is a small organization with a big mission—to put more farmers more securely on more land in New England and beyond.

Since 2004, LFG has specialized in farm access, tenure and transfer. From farmers' kitchen tables to the national arena, LFG helps farmers get onto, hold and transfer farms, and works to improve the conditions for secure and equitable farmland tenure.

We believe that farmland must be available, affordable, appropriate and secure within a variety of tenure arrangements. Taking a systems view, we address multiple aspects of the issue and work with all who have a stake in the future of farming. We promote diversity, innovation and land stewardship in all our work.

Direct Service We work directly with farm seekers, landowners and transitioning farm families. Our six field agents help seekers explore their land tenure options and landowners make land available for farming. Our unique coaching method and team approach support farm families through their succession planning. In 2016, our team handled over 360 new cases of direct advising assistance to farmers, landowners and community members.

Education & Training Often in partnership with other organizations, LFG regularly delivers over 40 workshops and presentations that reach thousands each year. Our educational materials such as our online Build-a-Lease tool, Acquiring Your Farm tutorial and guides for farmers without successors, non-farming landowners and the junior generation enable users to take informed action. We consult with and train organizations and professional networks in our six-state

region and across the country to build awareness of, and effective services, for land access, secure tenure and transfer. For example, we arranged for continuing education credits for attorneys and for real estate professionals who attend our trainings.

Advocacy LFG's advocacy work to improve local, state and federal policies is informed by our work on the ground and strengthened by regional and national collaborations. We work with state lawmakers and agency officials, and testify before Congress. Currently, we are collaborating on a scoping paper on land access and succession for the next Farm Bill.

Innovation We believe that the complex challenges of farmland access, tenure and transfer can only be successfully addressed with creative new ideas and partners. We collaborate with planning agencies, religious institutions, lenders, municipalities, and conservation groups, for example, to open up new possibilities for land access. Two Land Access Projects, funded by the USDA Beginning Farmer and Rancher Development Program (2010-13, 2015-18) have engaged over 50 collaborators. Our research into farmland investment companies, farmers without successors, and farm link programs, for example, has generated rich dialogue.

Our 12-member team—most currently farm or have farmed—brings a wealth of expertise and experience. We are a learning organization that builds our skills and programs through our own professional development, collaboration, and exposure to others' good work. Our annual budget of under \$500,000 is supported by foundation and government grants, contracts, donations and fees.

About the USDA

On May 15, 1862, President Abraham Lincoln signed legislation to establish the United States Department of Agriculture. Two and a half years later in his final message to Congress, Lincoln called USDA "The People's Department." Through our work on food, agriculture, economic development, science, natural resource conservation and other issues, USDA has impacted the lives of generations of Americans. USDA provides leadership on food, agriculture, natural resources, rural development, nutrition, and related issues based on public policy, the best available science, and effective management.

USDA's vision is to provide economic opportunity through innovation, helping rural America to thrive; to promote agriculture production that better nourishes Americans while also helping feed others throughout the world; and to preserve our Nation's natural resources through conservation, restored forests, improved watersheds, and healthy private working lands. USDA is made up of 29 agencies and offices with nearly 100,000 employees who serve the American people at more than 4,500 locations across the country and abroad.

Committees & Acknowledgements

Conference Planning Committee

- ▶ Adrian Card, Colorado State University Extension
- ▶ Julia Freedgood, American Farmland Trust
- ▶ Savi Horne, Land Loss Prevention Project
- ▶ Reggie Knox & Staff, California Farm Link
- ▶ Gary Matteson, Farm Credit
- ▶ Dana Richey, USDA Farm Service Agency
- ▶ Holly Rippon-Butler, National Young Farmers Coalition
- ▶ Hilde Steffey, Farm Aid
- ▶ Karen Stettler, Land Stewardship Project
- ▶ Severine von Tscherner Fleming, Agrarian Trust
- ▶ Kathryn Ruhf, Land Access Project Director and Conference Organizer, Land For Good

Colorado Host Committee

- ▶ Colorado Department of Agriculture
- ▶ Colorado State University
- ▶ Guidestone Colorado
- ▶ Rocky Mountain Farmers Union
- ▶ USDA Farm Service Agency, Colorado
- ▶ USDA Natural Resources Conservation, Colorado

Special thanks to the following individuals and groups:

- ▶ Adrian Card, Bill Stevenson and all the local and regional producers and distributors whose food items grace our tables
- ▶ Rocky Mountain Farmers Union for printing the conference program
- ▶ Colorado State University and Martha Sullins for lending AV equipment
- ▶ Video Squad: Holly, Liya, Kerry, Kate, Tess, and Neil
- ▶ All our session scribes
- ▶ Laura Nelson, Chef Matt and the DoubleTree Stapleton North staff
- ▶ Broken Banjo Photography | brokenbanjo.net
- ▶ Seth Gregory Design | sethgregorydesign.com

Rememberance

Kathy Ozer was the executive director of the National Family Farm Coalition for 24 years. Despite battling the cancer which took her life at 58, Kathy served on the Conference Planning Committee until her death this past January. Kathy was an early champion of sustainable agriculture and a tireless advocate of family farmers. She fought for policies to keep farmers on their land. US Representative Marcy Kaptur (D-Ohio) said, "Kathy remains in the top tier of Americans who have made a difference." Kathy is deeply missed.



Thanks to these generous sponsors for supporting our national conference.

Sponsorships were used for presenter and attendee registration scholarships, travel, and lodging assistance. Sponsor contributions also underwrote registration fees for everyone, and helped with AV and other direct expenses.

Without this support the conference would not have been possible.



United States Department of Agriculture
National Institute of Food and Agriculture

Additional support has been provided by a grant from the USDA National Institute of Food and Agriculture through its Beginning Farmer and Rancher Development Program, #2015-70017-23900.